

“LEADER IN ANIMAL CARE PRODUCTS FOR OVER 60 YEARS”



SSCI

SUBURBAN SURGICAL Co., INC.

275 Twelfth Street, Wheeling, IL 60090

All intellectual material, including the text, graphics and other components of this catalog are Copyrighted by SSCI. Any use or duplication of these intellectual materials, without written consent by SSCI, is strictly forbidden.

Catalog No. 702488-0308

For Product Information Call TOLL-FREE 1-800-323-7366 • (847) 537-9320 • Fax (847) 537-9061

Hours: 8:30am - 5:00pm CST Monday - Friday

Visit our website at: www.suburbansurgical.com

IMPERIAL MODULAR CABINETRY

YOU CAN TRUST SSCI TO OFFER PROFESSIONAL QUALITY CABINETRY IN THE WIDEST RANGE OF STYLES, SIZES AND FINISHES YOU'LL FIND!

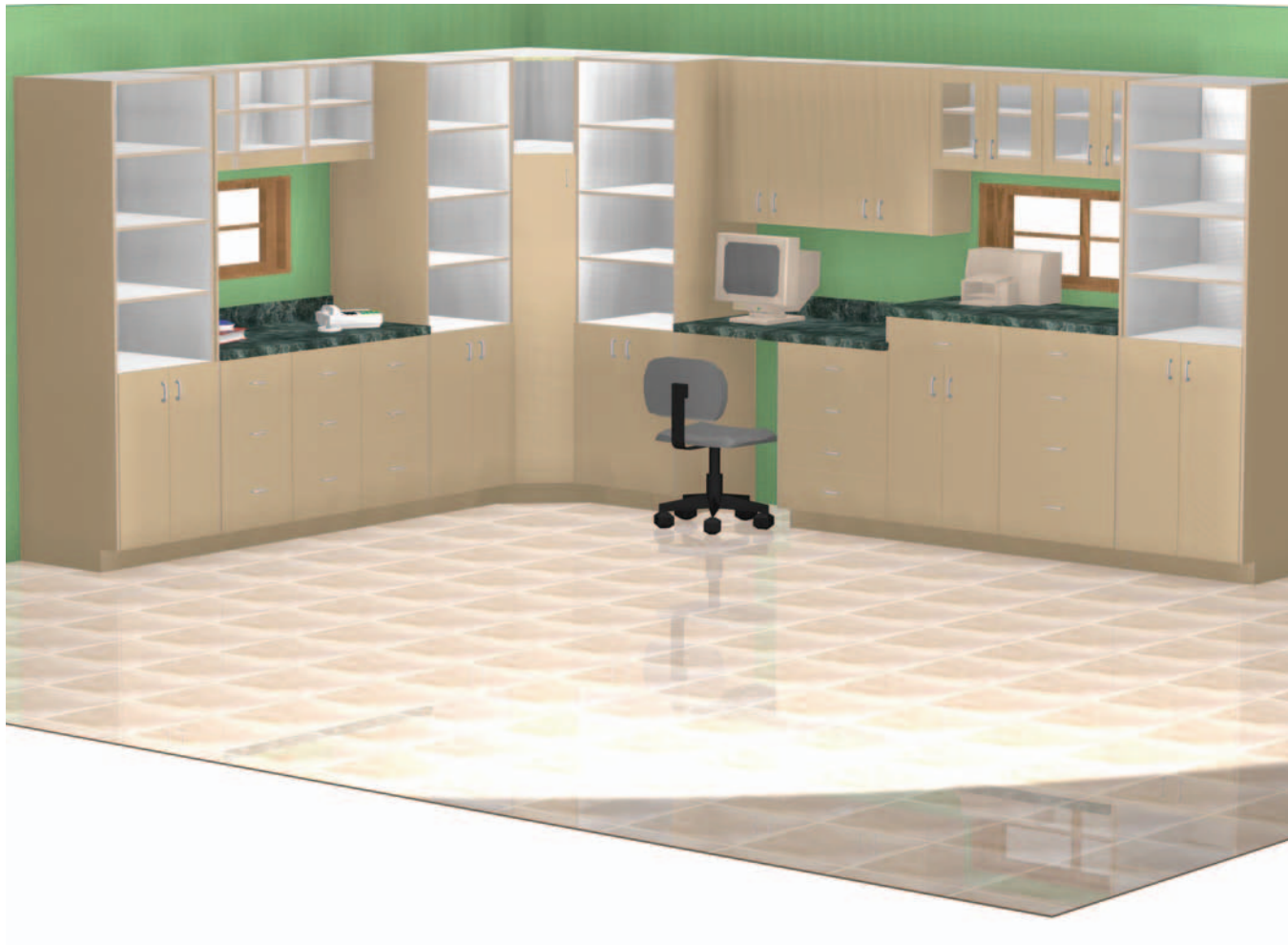

Professionalism is an important aspect of any veterinary business. Your clients depend on it. The success of your business requires it. Just imagine how professional your business will look when you take the time to outfit each room with coordinated modular cabinetry designed to meet your individual exam, treatment and storage requirements.

You can do just that with help from SSCI. We offer a complete selection of cabinets in a wide range of sizes and styles and virtually any laminated color you desire. With such a large selection, it's easy to perfectly outfit each area within your facility.

All our Cabinetry features our top-quality construction details: Self-

closing drawers with integrated metal drawer sides and slides; adjustable shelves; and a choice of two standard cabinet handles to suit your style.

Most cabinets are available in a selection of widths that increase in 3-in. (7.62cm) increments to allow you to build a bank of cabinets to fit your rooms. We also offer a full collection of end panels, filler strips and countertops to give your cabinetry a finished appearance.

The cabinets on the following page are the types we can provide to make your facility one-of-a-kind. Be sure to call your SSCI representative for help designing and ordering the ideal cabinetry for your needs.



Choose from four basic cabinet types:

Each of the four cabinet types shown on this page are available in many styles. Various combinations of open cupboard and doors/drawers styles are offered on the pages that follow.

• Imperial Upper Cabinets

Choose open cupboards with no doors, cupboards with sliding or hinged doors. All have adjustable shelves to meet your needs. We even offer pass-thru cupboards to pass materials between two rooms.



Open Cabinet

**3-Drawer
Undercounter
Cabinet**



• Imperial Wall-Mount Undercounter Cabinets

Designed to mount on the wall at the right height for the job while leaving the floor clear underneath. Allows for ample storage with easy clean-up. Choose from open cabinets, or those with drawers or hinged doors. Specially designed desk drawer or keyboard drawer cabinets are available for convenience.



**Undercounter 1 Drawer,
1 Door Hinged Cabinet**

• Imperial Full Height Cabinets

A wide variety of cupboards featuring one vertical cupboard or two vertical cupboards in three different combinations give you incredible storage possibilities.



**1 Door Hinged
over 1 Door
Hinged**



1 Door Hinged

• Imperial Undercounter Cabinets

Available in three heights for reception, standard and exam. A huge selection of drawer/cupboard combinations gives you a place to store everything from client files to treatment supplies.

Imperial Modular Cabinetry

IMPERIAL LAMINATED CABINET PREP-PROCEDURE TABLES INCLUDE THESE FEATURES:

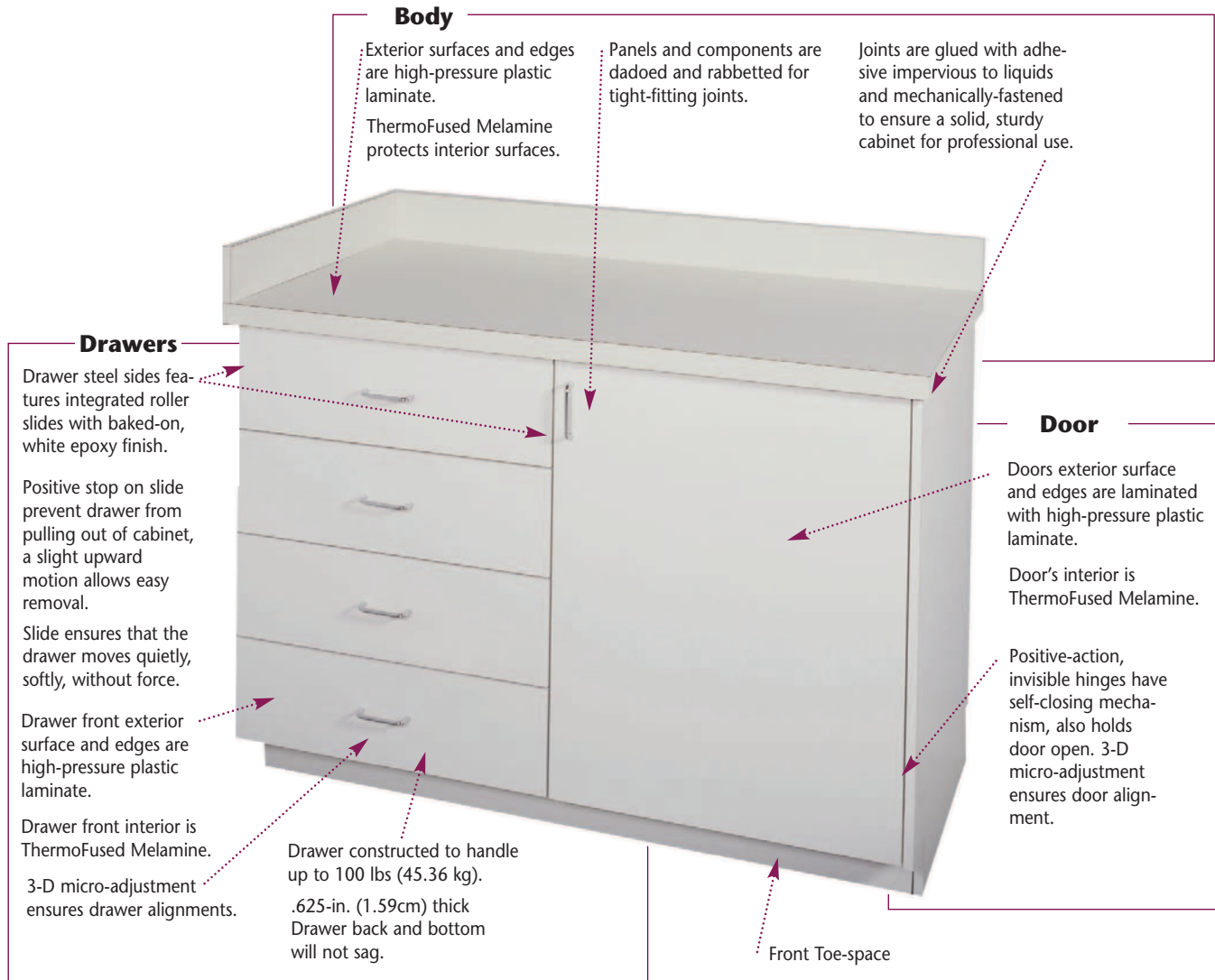

Imperial Prep-Procedure Table body panels are constructed of 45-lb. industrial-grade substrate, panels are machined on a CNC machine for accuracy. Panels are dadoed and rabbetted for tight-fitting joints. Joints are glued with adhesive impervious to liquids and mechanically-fastened to ensure a solid, sturdy cabinet.

All cabinet interiors are finished with Thermo-Fused Melamine, making them water, odor and chemical-resistant.

Drawer's steel sides feature integrated roller slides with baked-on, white epoxy finish. Drawer's back/bottom are .625-in. thick; open/close easily with 100 lb. load. 3D micro-adjustment ensures drawer alignment.

Door's positive-action, invisible hinges have self-closing mechanism, also holds door open. 3D micro-adjustment ensures door alignment.

Choose No Pulls, Chrome Wire Pulls or Full-Width Aluminum Pulls for doors and drawer fronts.

All finished, exterior surfaces including the body's edges, drawer and cupboard door edges are laminated with high-pressure plastic laminate, available in SSCI Standard colors, or SSCI optional colors or choose from a spectrum of customer-selected colors to blend with your décor.



SPECIFY OPTIONS

When discussing your Imperial Modular Cabinetry with SSCI's representatives, be sure to select any of the options below that you would like incorporated into your cabinets.

Specify a Towel Drop for most Cabinet Doors:

A convenient 6-in. wide x 6-in. high (15.24cm x 15.24cm) Towel Drop may be added to most Cabinet Doors. Towel Drops may be specified in cabinet doors: hinged left, hinged right and the left or right panel of pairs of doors.



Specify a Privacy Key Lock for a Cabinet:

Locks are designed for privacy, not security.

Choose one of the options below:

For each Cabinet:

- One lock if all drawers.
- One lock if door(s).
- One lock for each tier of door(s).
- Two locks; drawer above door(s).

SPECIFY THE WIDTH OF EACH CABINET:

To help you design your cabinetry for a custom fit in your space, all our Cabinets (except Corner Cabinets) are available in 11 different widths, increasing in 3-in. (7.62cm) increments. To specify the width of each Cabinet, you must add the Width Dimension Code to the Product Number. Refer to the dimension chart for the correct code needed to complete the Product Number for each cabinet you order.

You must select a cabinet width to complete the Product Number for each Cabinet you order. Simply place the appropriate 2-digit Width Code for the width you prefer (see chart at right) into the 10th and 11th digits in the cabinet Product number.

Width Dimension Chart

P/N CODE	WIDTH	
	In.	Cm
BV	12	30.48
CH	15	38.10
CT	18	45.72
DF	21	53.34
DR	24	60.96
ED	27	68.58
EP	30	76.20
FB	33	83.82
FN	36	91.44
FZ	39	99.06
GL	42	106.68



SPECIFY A PULL STYLE:

All Imperial Modular Cabinets may be ordered with no drawer/door pulls or with Chrome Wire Pulls or Full-Width Aluminum Pulls. Full-Width Aluminum Pulls protect the edges of drawers and doors.

Order No Pulls if you wish to add separately-purchased pulls to the cabinet's drawers and doors. this option allows for

customer-selected decorating consistency throughout your facility.

You must select one of these options to complete the Product Number for each Cabinet you order. Simply place the appropriate letter for the pull style you prefer (see below) into the 9th digit in the cabinet Product number.

No Pulls, specify 'A' in 9th digit

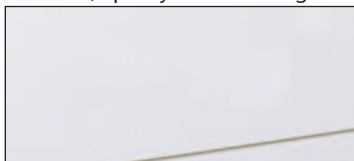

No Pulls

Chrome Wire Pulls, specify 'B' in 9th digit



Chrome wire Pulls

Full-width Aluminum Pulls, specify 'C' in 9th digit



Full-width Aluminum Pulls

Laminates For Imperial Modular Cabinetry

CHOOSE A LAMINATE:

A Spectrum of Colors and Finishes

SSCI Laminated Products are available in virtually all commercially-available high-pressure laminates. Most laminates are available in a spectrum of colors and finishes to match or coordinate any décor. We'll will make any of our laminated products in any of these available laminates. We want to be your supplier for the color-coordinated equipment and furnishings you need to give your facility the greatest client appeal.

SSCI's Standard Laminates and SSCI Optional Laminates are shown here. However keep in mind, we can build your laminated products in virtually any laminate available.

The SSCI Standard Colors listed below are included in the selling price of the product. Manufacturing Lead Time is also based on SSCI Standard Colors. SSCI Optional Colors (Price Levels 1 and 2) are available at a additional charge, but SSCI will adhere to the standard Manufacturing Lead Times for the products chosen.

Optional Laminates may become discontinued from time-to-time and SSCI retains the right to change the Optional Laminate selection when necessary.

Customer-selected laminates may fall into the category of Price Levels 1 or 2 or higher, depending on market price. Manufacturing lead times for laminated products made with customer-selected laminates may vary.



SSCI laminated products are available in SSCI standard laminates, SSCI optional laminates, or Customer selected laminates.

Look for this Color Wheel on pages where laminate needs to be specified (_ _ _ †).

Standard Laminates



COLOR NAME	SSCI NUMBER	MANUFACTURER/NUMBER
Almond	A001 [†]	Wilson Art/D30-60 Matte
Designer White	D001 [†]	Wilson Art/D354-60 Matte
Fashion Grey	F002 [†]	Wilson Art/D381-60 Matte

Important: These customer order requirements, in addition to other customer order requirements, must be satisfied prior to the beginning of manufacturing lead time:
[†]Specify 4-digit Code to select Laminate/Color. See this Section, pages 5 & 6 for Laminate/Color Codes.

Optional Laminates: Price Level 1 - increase over SSCI Standard laminates



LAMINATE NAME	SSCI NUMBER	MANUFACTURER/NUMBER
Pebble	P032†	Wilson Art/D337-60
Beige Nebula	B031†	Wilson Art/4624-60
Indigo	I008†	Wilson Art/D379-60
Mystique Marsh	M022†	Wilson Art/4763-60
Fusion Maple	F013†	Wilson Art/7909-60
Bannister Oak	B001†	Wilson Art/7806-60

Optional Laminates: Price Level 2 - increase over SSCI Standard laminates

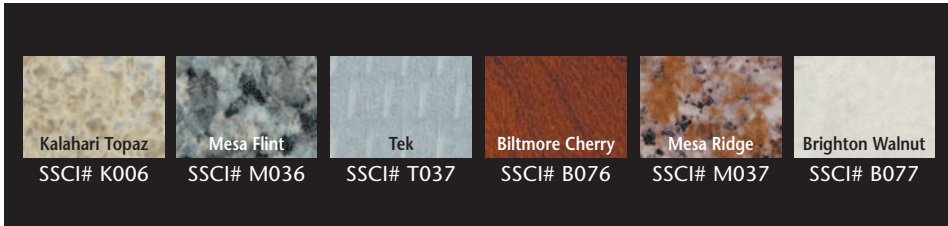

LAMINATE NAME	SSCI NUMBER	MANUFACTURER/NUMBER
Kalahari Topaz	K006†	Wilson Art/5488-07
Mesa Flint	M036†	Wilson Art/4576-07
Tek	T037†	Wilson Art/4828-07
Biltmore Cherry	B076†	Wilson Art/7924-07
Mesa Ridge	M037†	Wilson Art/4577-07
Brighton Walnut	B077†	Wilson Art/7922-07

Important: These customer order requirements, in addition to other customer order requirements, must be satisfied prior to the beginning of manufacturing lead time:
 †Specify 4-digit Code to select Laminate/Color. See this Section, pages 5 & 6 for Laminate/Color Codes.



SSCI laminated products are available in SSCI standard laminates, SSCI optional laminates, or Customer selected laminates.

Drawer Sizes For Imperial Modular Cabinetry

Drawer Dimensions

The description of Cabinets with drawers includes the Type of Drawer.

Top View of drawer shows inside dimensions:

- A Side-to-Side (deduct 2.5-in., 6.35cm from the width of the selected cabinet)
- B Front-to-Back (for 18-in. 45.72cm deep cabinet drawer is 15-in. 38.10cm)
(for 24-in. 60.96cm deep cabinet drawer is 20.875-in. 53.02cm)

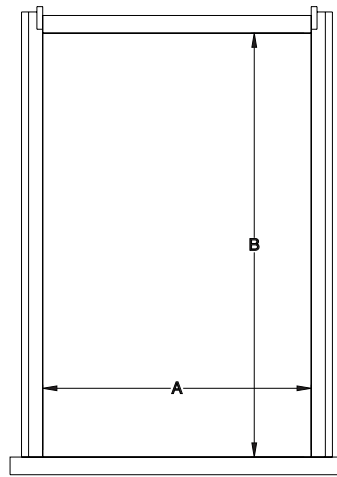

Top View

The Drawer Type Chart shows the depth of each type of drawer.

- C height of an object that can be placed into drawer.
- D height of drawer sides and back

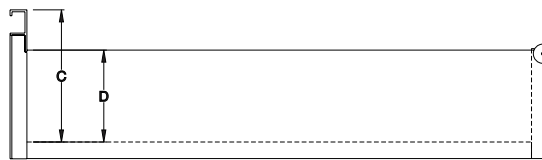

Side View

Drawer Type Chart

Drawer Type	Dimensions			
	C		D	
	In.	Cm	In.	Cm
B	3.00	7.62	2.50	6.35
C	4.25	10.79	3.75	9.53
D	5.50	13.97	5.00	12.70
E	6.75	17.14	5.00	12.70
F	8.00	20.32	7.50	19.05
G	9.25	23.50	7.50	19.05
H	10.50	26.76	7.50	19.05
I (File)				
K (Keyboard)	3.00	7.62	0	0
L	6.25	15.87	5.00	12.70

Design Service For Imperial Modular Cabinetry

THE PERFECT IMPERIAL MODULAR CABINET ARRANGEMENT IS JUST A PHONE CALL AWAY

SSCI's Design Service is offered to customers after discussing and agreeing on a viable project with an SSCI Representative. After a methodical review of the customer's needs for their facility, the SSCI Representative will present the project to our staff of designers to create a set of approval drawings. The drawings ensure that SSCI will

build exactly what the customer has discussed with the SSCI Representative. Once the customer has committed to purchase from SSCI and, if the drawings require revisions, the Final Approval Drawings will be created and presented to the customer for their approval. Other Customer Requirements may be required before manufacturing time can begin.

CREATING THE PERFECT IMPERIAL MODULAR CABINET ARRANGEMENT TAKES JUST 5 EASY STEPS:

1 Measure your space.

Obtain overall width, height and depth of the available space in your facility where you plan to place your Imperial Cabinet Arrangement. To allow for the cabinet, the minimum depth of the area must be 18-in. (45.72cm) or 24-in. (60.96cm) plus the width of the widest cabinet door in the arrangement. This will allow cabinet doors to open fully. Make sure you have sufficient space in front of the cabinet arrangement for your staff to work efficiently.

2 Choose the type and style of the Imperial Cabinets in your Arrangement.

SSCI offers the most complete line of cabinetry available in the market.

3 Identify the Imperial Cabinet sizes you require.

A variety of sizes can be used in a single Arrangement. An idea of the area's use will help you select the sizes you need, for example; exam, treatment, pharmacy, laboratory, food preparation, reception and general storage.

4 Determine how your Cabinets will be arranged.

Take some time to consider the work procedures throughout your facility and arrange your cabinets for maximum efficiency

5 Choose the color or colors for your Cabinet Arrangement.

SSCI Imperial Modular Cabinetry are available in SSCI standard colors, SSCI optional colors, or a spectrum of customer-selected colors. See the Laminate Color pages in this Section.

Let us help you give your facility the professional appearance you deserve. An SSCI Representative will help you select cabinet styles and sizes, cabinet laminate and countertop surfaces to meet your unique needs, space requirements and budget.

Let SSCI assist your architect and to help plan the perfect facility.

It all starts with a phone call to discuss your requirements. Then we will create a CAD-generated drawing of your cabinets, complete with all finishing compo-

nents you'll need to get a built-in look.



Our team of experienced designers will work with your measurements, cabinet type, style and budget to create the perfect Cabinet Arrangement for your requirements.

FOR EVERY CABINET ARRANGEMENT PURCHASE SSCI CREATES A DRAWING TO ENSURE CUSTOMER'S SATISFACTION

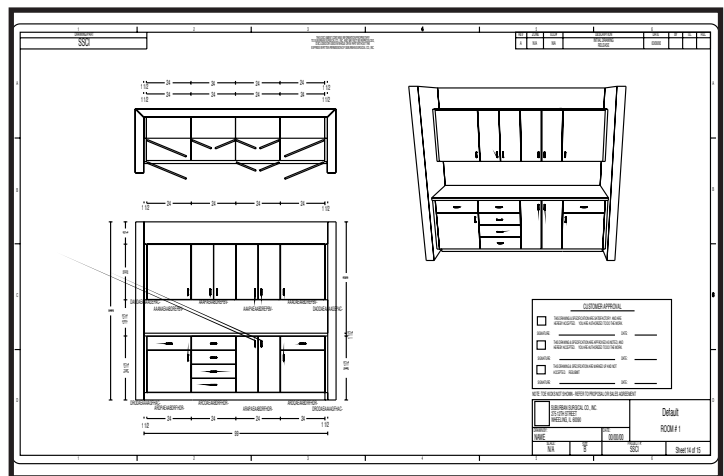

SSCI creates an Approval Drawing for each cabinet arrangement ordered. These detailed drawings of your cabinet arrangement list cabinet sizes, quantities, laminate choice and all appropriate finishing components and illustrate how the arrangement is to be assembled. If you choose to alter the positions of the cabinets in the arrangement or your choice of laminate, do not sign the existing Approval Drawing. Contact your SSCI representative, so that a new Approval Drawing can be created. All laminated products are non-stocked, made specifically per your specifications. Once SSCI has received the signed Approval Drawing the order is non-cancelable. In addition to other customer requirements, the Final Approval Drawings must be signed and received by SSCI prior to the beginning of manufacturing lead time.

Use Of Finishing Components

FILLER STRIPS

Installation against 1 wall

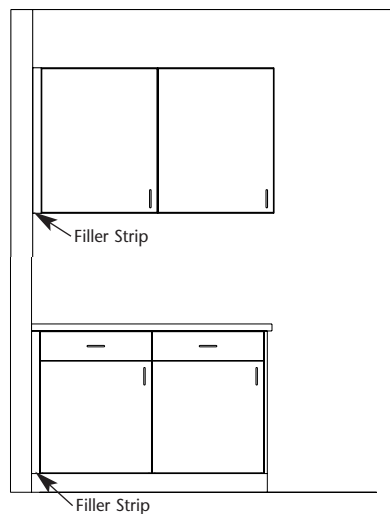

Installation between 2 walls

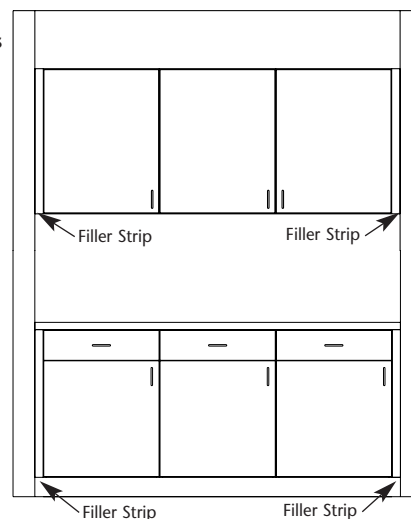

USE OF FILLER STRIPS

Filler Strips are used when cabinet's ends abut to walls. Filler Strips are fitted to fill the space and scribed to compensate for wall's plumbness by the installer. They create clearance to prevent drawers, when being pulled out, from rubbing against the wall. Filler Strips are 'L'-shaped and both the face and the side are laminated with high-pressure laminate. Laminating both exposed surfaces of the 'L' shape allows for aligning the face of the Filler Strip flush with the face of the cabinet's doors and drawers to create a custom installation. Select the same laminate/color as chosen for the cabinets.

Installations Against One Wall:

A Filler Strip is used between the end of the cabinet and the abutting wall. The space between the end of the cabinet and the wall should be at least 1-in.

Installations Cabinets Between Two Walls:

Filler Strips are used on both ends of the cabinets, centering the cabinet installation between the two walls. The total width of the cabinets to be installed between two walls should be at least 2-in. less than the space between the two walls.

INSIDE 90° CORNERS

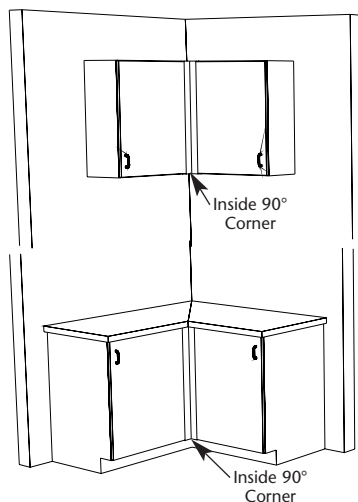

USE OF INSIDE 90° CORNERS

Inside Corners are used when cabinet's are installed on two walls that are 90° to each other and no corner cabinet is used. The Inside Corner is used to create clearance to prevent drawers, when being pulled out, and doors, when opening, from rubbing against the cabinet front installed at 90°. Inside 90° Corners are 'W'-shaped and both faces and both sides are laminated with high-pressure laminate. Laminating the faces and sides of 'W' shape allows for aligning the faces of the Inside 90° Corners flush with the faces of the cabinet's doors and drawers to create a custom installation. Select the same laminate/color as chosen for the cabinets.

USE OF CORNER FOR T-MOUNTING TREATMENT/PREP-PROCEDURE TABLES

Inside Corners are used when tables are abutted to floor-standing cabinets at a 90° angle. The Inside Corner is used to create clearance to prevent drawers, when being pulled out, and doors, when opening, from rubbing against the cabinet front installed at 90°. Inside 90° Corners are 'W'-shaped and both faces and both sides are laminated with high-pressure laminate. Laminating the faces and sides of 'W' shape allows for aligning the faces of the Inside 90° Corners flush with the faces of the cabinet's doors and drawers to create a custom installation. Select the same laminate/color as chosen for the cabinets.

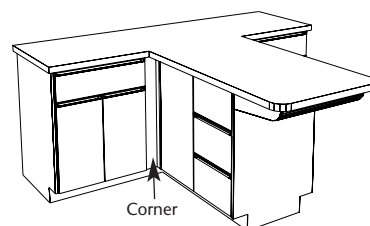

END PANELS

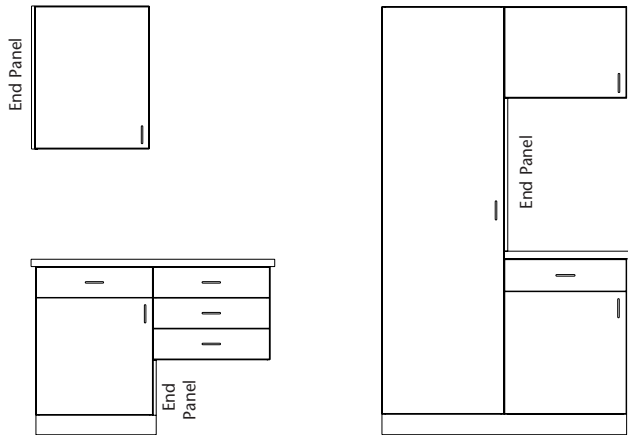

USE OF END PANELS

End Panels are used on the exposed ends of a cabinet to give the cabinet a finished appearance. End Panels are flat panels, both sides and the front edge are laminated with high-pressure laminate. Laminating both sides allows for aligning the edge of the End

Panel flush with the face of the cabinet's doors and drawers to create a custom installation. Select the same laminate/color as chosen for the cabinets.

TOE KICKS

USE OF TOE KICK

Toe Kicks are used to finish the recessed toe space at the bottom of the cabinets, to give the cabinet installation a finished appearance. Toe Kicks are a strip, one side is laminated with high-pressure laminate. Select the same laminate/color as chosen for the cabinets.

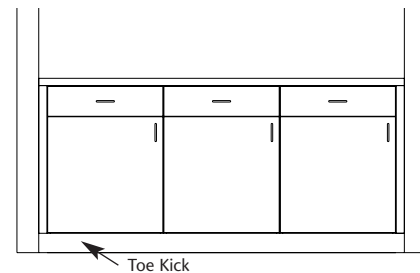

BACK PANELS

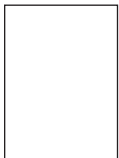

USE OF BACK PANELS

Back Panels are used on the exposed backs of a cabinet to give the cabinet a finished appearance. Back Panels are flat panels, one side and the top edge are laminated with high-pressure laminate. Select the same laminate/color as chosen for the cabinets.

Imperial Upper Cabinets

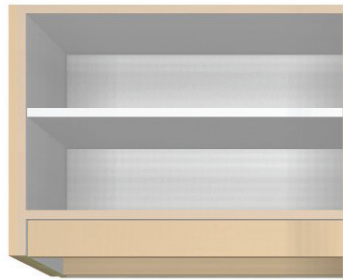

Open Cabinet, 18-in. (45.72cm) H

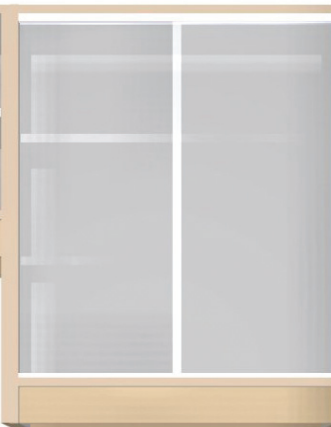

Cabinet with Pair of Acrylic Sliding Doors, 30-in. (76.20cm) H



Cabinet with Pair of Hinged Doors, 36-in. (91.44cm) H



Imperial 18-in. (45.72cm)H Upper Cabinets

Open

1 adjustable shelf

Width: 12-in. to 42-in. (30.48cm to 106.68cm) in 3-in. (7.62cm) increments

Height: 18-in. (45.72cm)



P/N	DEPTH	
	In.	Cm
AAAAAAAA * CTBD - _ _ _ _ †	7.375	18.47
AAAAAAAA * CTBT - _ _ _ _ †	11.375	28.89

Open Corner

1 adjustable shelf

Width: 12-in. (30.48cm)

Height: 18-in. (45.72cm)



P/N	DEPTH	
	In.	Cm
ADAAAAAAAA BVCTBD - _ _ _ _ †	7.375	18.47
ADAAAAAAAA BVCTBT - _ _ _ _ †	11.375	28.89

1 Door Hinged left or right

1 adjustable shelf

Width: 12-in. to 24-in. (30.48cm to 60.96cm) in 3-in. (7.62cm) increments

Height: 18-in. (45.72cm)



P/N			DEPTH	
	Hinged Left	Hinged Right	In.	Cm
AAANAEAA ◊ ** CTBF - _ _ _ _ †	AAAOAEAA ◊ ** CTBF - _ _ _ _ †	8	20.32	
AAANAEAA ◊ ** CTBV - _ _ _ _ †	AAAOAEAA ◊ ** CTBV - _ _ _ _ †	12	30.48	

Pair of Hinged Doors

1 adjustable shelf

Width: 21-in. to 42-in. (53.34cm to 106.68cm) in 3-in. (7.62cm) increments

Height: 18-in. (45.72cm)



P/N	DEPTH	
	In.	Cm
AAAPAEAA ◊ ** CTBF - _ _ _ _ †	8	20.32
AAAPAEAA ◊ ** CTBV - _ _ _ _ †	12	30.48

1 Door Hinged left or right, Corner

1 adjustable shelf

Width: 12-in. (30.48cm)

Height: 18-in. (45.72cm)



P/N			DEPTH	
	Hinged Left	Hinged Right	In.	Cm
ADANAEAA ◊ BVCTBF - _ _ _ _ †	ADAOAEAA ◊ BVCTBF - _ _ _ _ †	8	20.32	
ADANAEAA ◊ BVCTBV - _ _ _ _ †	ADAOAEAA ◊ BVCTBV - _ _ _ _ †	12	30.48	

Important: These customer order requirements, in addition to other customer order requirements, must be satisfied prior to the beginning of manufacturing lead time:

◊ Specify 1-digit Code to select type of drawer/door pull(s). See this Section, page 4 for drawer/door Pull Codes.

* Specify 2-digit Code to select Cabinet Width. See this Section, page 4 for Cabinet Width Codes.

† Specify 4-digit Code to select Laminate/Color. See this Section, pages 5 & 6 for Laminate/Color Codes.



SSCI laminated products are available in SSCI standard laminates, SSCI optional laminates, or Customer selected laminates.

For Product Information Call TOLL-FREE 1-800-323-7366 • (847) 537-9320 • Fax (847) 537-9061

Hours: 8:30am - 5:00pm CST Monday - Friday

Visit our website at: www.suburbansurgical.com

Imperial 18-in. (45.72cm)H Upper Cabinets

Pair of Acrylic Sliding Doors

1 adjustable shelf

Width: 21-in. to 42-in. (53.34cm to 106.68cm) in 3-in. (7.62cm) increments

Height: 18-in. (45.72cm)



P/N	DEPTH	
	In.	Cm
Clear Acrylic Insert		
AAABAGAAA ** CTBD - _ _ _ †	7.375	18.47
AAABAGAAA ** CTBT - _ _ _ †	11.375	28.89
Tinted Acrylic Insert		
AAABAHAAA ** CTBD - _ _ _ †	7.375	18.47
AAABAHAAA ** CTBT - _ _ _ †	11.375	28.89

1 Frame Door with Acrylic Insert, Hinged left or right

1 adjustable shelf

Widths: 12-in. to 24-in. (30.48cm to 60.96cm) in 3-in. (7.62cm) increments

Height: 18-in. (45.72cm)



P/N	DEPTH	
	In.	Cm
Clear Acrylic Insert		
AAANAOAA ◊ ** CTBF - _ _ _ †	8	20.32
AAANAOAA ◊ ** CTBV - _ _ _ †	12	30.48
Tinted Acrylic Insert		
AAANAPAA ◊ ** CTBF - _ _ _ †	8	20.32
AAANAPAA ◊ ** CTBV - _ _ _ †	12	30.48

Pair of Framed Doors with Acrylic Insert, Hinged

1 adjustable shelf

Width: 21-in. to 42-in. (53.34cm to 106.68cm) in 3-in. (7.62cm) increments

Height: 18-in. (45.72cm)



P/N	DEPTH	
	In.	Cm
Clear Acrylic Insert		
AAAPAOAA ◊ ** CTBF - _ _ _ †	8	20.32
AAAPAOAA ◊ ** CTBV - _ _ _ †	12	30.48
Tinted Acrylic Insert		
AAAPAPAA ◊ ** CTBF - _ _ _ †	8	20.32
AAAPAPAA ◊ ** CTBV - _ _ _ †	12	30.48

1 Frame Door with Acrylic Insert, Hinged left or right, Corner

1 adjustable shelf

Width: 12-in. (30.48cm)

Height: 18-in. (45.72cm)



P/N	DEPTH	
	In.	Cm
Clear Acrylic Insert		
ADANAOAA ◊ BVCTBF - _ _ _ †	8	20.32
ADANAOAA ◊ BVCTBV - _ _ _ †	12	30.48
Tinted Acrylic Insert		
ADANAPAA ◊ BVCTBF - _ _ _ †	8	20.32
ADANAPAA ◊ BVCTBV - _ _ _ †	12	30.48

Important: These customer order requirements, in addition to other customer order requirements, must be satisfied prior to the beginning of manufacturing lead time:

◊ Specify 1-digit Code to select type of drawer/door pull(s). See this Section, page 4 for drawer/door Pull Codes.

* Specify 2-digit Code to select Cabinet Width. See this Section, page 4 for Cabinet Width Codes.

† Specify 4-digit Code to select Laminate/Color. See this Section, pages 5 & 6 for Laminate/Color Codes.



SSCI laminated products are available in SSCI standard laminates, SSCI optional laminates, or Customer selected laminates.

Finishing Components For Imperial 18-in. (45.72cm)H Upper Cabinets

**Installation
against 1 wall**

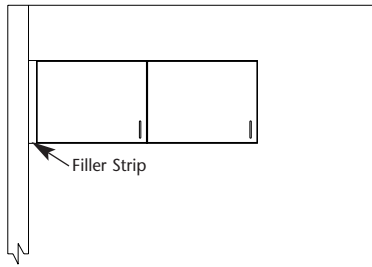

**Installation
between 2 walls**

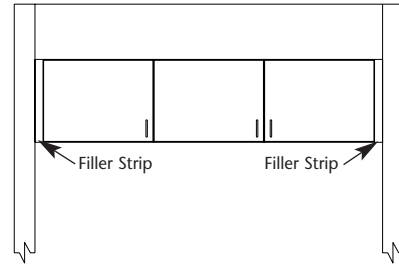

Filler Strips for Upper Cabinets

P/N	WIDE		HEIGHT		DEPTH	
	In.	Cm	In.	Cm	In.	Cm
DAODAEAAAAGCTAC-___†	1.75	4.45	18	45.72	.625	1.59
DAODAEAAAANCTAC-___†	3.50	8.89	18	45.72	.625	1.59

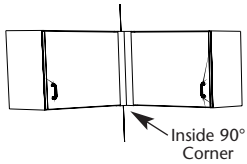

Inside 90° Corner for Upper Cabinets

P/N	WIDE		HEIGHT		DEPTH	
	In.	Cm	In.	Cm	In.	Cm
DAOAAEAAAICTAI-___†	2.25	5.715	18	45.72	2.25	5.715

End Panels for Upper Cabinets

End Panel; 18-in. (45.72cm) H



P/N	THICKNESS		HEIGHT		DEPTH	
	In.	Cm	In.	Cm	In.	Cm
DAOKAEAAAACCTBD-___†	.625	1.59	18	45.72	7.375	18.73
DAOKAEAAAACCTBF-___†	.625	1.59	18	45.72	8	20.32
DAOKAEAAAACCTBT-___†	.625	1.59	18	45.72	11.375	28.89
DAOKAEAAAACCTBV-___†	.625	1.59	18	45.72	12	30.48

Back Panels for Upper Cabinets

Back Panel Custom Widths; Upper 18-in. (45.72cm) H



P/N	WIDTH		HEIGHT		THICKNESS	
	In.	Cm	In.	Cm	In.	Cm
DAOMAEAAA *_* CTAA-___†	As Required		18	45.72	.625	1.59

Important: These customer order requirements, in addition to other customer order requirements, must be satisfied prior to the beginning of manufacturing lead time:

*Specify 2-digit Code to select Cabinet Width. See this Section, page 4 for Cabinet Width Codes.

†Specify 4-digit Code to select Laminate/Color. See this Section, pages 5 & 6 for Laminate/Color Codes.



SSCI laminated products are available in SSCI standard laminates, SSCI optional laminates, or Customer selected laminates.

For Product Information Call TOLL-FREE 1-800-323-7366 • (847) 537-9320 • Fax (847) 537-9061

Hours: 8:30am - 5:00pm CST Monday - Friday

Visit our website at: www.suburbansurgical.com

Imperial 30-in. (76.20cm)H Upper Cabinets



Open

2 adjustable shelves

Width: 12-in. to 42-in. (30.48cm to 106.68cm) in 3-in. (7.62cm) increments

Height: 30-in. (76.20cm)

P/N	DEPTH	
	In.	Cm
AAAAAAAAA * _ EPBD - _ _ _ _ †	7.375	18.47
AAAAAAAAA * _ EPBT - _ _ _ _ †	11.375	28.89

Open Corner

2 adjustable shelves

Width: 12-in. (30.48cm)

Height: 30-in. (76.20cm)



P/N	DEPTH	
	In.	Cm
ADAAAAAAAAABVEPBD - _ _ _ _ †	7.375	18.47
ADAAAAAAAAABVEPBT - _ _ _ _ †	11.375	28.89

1 Door Hinged left or right

2 adjustable shelves

Width: 12-in. to 24-in. (30.48cm to 60.96cm) in 3-in. (7.62cm) increments

Height: 30-in. (76.20cm)



P/N	DEPTH	
	In.	Cm
AAANAEEA ◊ * * EPBF - _ _ _ _ †	8	20.32
AAANAEEA ◊ * * EPBV - _ _ _ _ †	12	30.48
AAAOEEA ◊ * * EPBF - _ _ _ _ †	8	20.32
AAAOEEA ◊ * * EPBV - _ _ _ _ †	12	30.48

Pair of Hinged Doors

2 adjustable shelves

Width: 21-in. to 42-in. (53.34cm to 106.68cm) in 3-in. (7.62cm) increments

Height: 30-in. (76.20cm)



P/N	DEPTH	
	In.	Cm
AAAPAEAA ◊ * * EPBF - _ _ _ _ †	8	20.32
AAAPAEAA ◊ * * EPBV - _ _ _ _ †	12	30.48

1 Door Hinged left or right, Corner

2 adjustable shelves

Width: 12-in. (30.48cm)

Height: 30-in. (76.20cm)



P/N	DEPTH	
	In.	Cm
ADANAEEA ◊ BVEPBF - _ _ _ _ †	8	20.32
ADANAEEA ◊ BVEPBV - _ _ _ _ †	12	30.48
ADAOEEA ◊ BVEPBF - _ _ _ _ †	8	20.32
ADAOEEA ◊ BVEPBV - _ _ _ _ †	12	30.48

Important: These customer order requirements, in addition to other customer order requirements, must be satisfied prior to the beginning of manufacturing lead time:

◊ Specify 1-digit Code to select type of drawer/door pull(s). See this Section, page 4 for drawer/door Pull Codes.

* Specify 2-digit Code to select Cabinet Width. See this Section, page 4 for Cabinet Width Codes.

† Specify 4-digit Code to select Laminate/Color. See this Section, pages 5 & 6 for Laminate/Color Codes.



SSCI laminated products are available in SSCI standard laminates, SSCI optional laminates, or Customer selected laminates.

Imperial 30-in. (76.20cm)H Upper Cabinets

Pair of Acrylic Sliding Doors

2 adjustable shelves

Width: 21-in. to 42-in. (53.34cm to 106.68cm) in 3-in. (7.62cm) increments

Height: 30-in. (76.20cm)



P/N	DEPTH	
	In.	Cm
Clear Acrylic Insert		
AAABAGAAA ** EPBD - _ _ _ †	7.375	18.47
AAABAGAAA ** EPBT - _ _ _ †	11.375	28.89
Tinted Acrylic Insert		
AAABAHAAA ** EPBD - _ _ _ †	7.375	18.47
AAABAHAAA ** EPBT - _ _ _ †	11.375	28.89

1 Frame Door with Acrylic Insert, Hinged left or right

2 adjustable shelves

Widths: 12-in. to 24-in. (30.48cm to 60.96cm) in 3-in. (7.62cm) increments

Height: 30-in. (76.20cm)



P/N	Hinged Left	Hinged Right	DEPTH	
			In.	Cm
Clear Acrylic Insert				
AAANAOAA ◊ ** EPBF - _ _ _ †		AAAOAOAA ◊ ** EPBF - _ _ _ †	8	20.32
AAANAOAA ◊ ** EPBV - _ _ _ †		AAAOAOAA ◊ ** EPBV - _ _ _ †	12	30.48
Tinted Acrylic Insert				
AAANAPAA ◊ ** EPBF - _ _ _ †		AAAOAPAA ◊ ** EPBF - _ _ _ †	8	20.32
AAANAPAA ◊ ** EPBV - _ _ _ †		AAAOAPAA ◊ ** EPBV - _ _ _ †	12	30.48

Pair of Framed Doors with Acrylic Insert, Hinged

2 adjustable shelves

Width: 21-in. to 42-in. (53.34cm to 106.68cm) in 3-in. (7.62cm) increments

Height: 30-in. (76.20cm)



P/N	DEPTH	
	In.	Cm
Clear Acrylic Insert		
AAAPAOAA ◊ ** EPBF - _ _ _ †	8	20.32
AAAPAOAA ◊ ** EPBV - _ _ _ †	12	30.48
Tinted Acrylic Insert		
AAAPAPAA ◊ ** EPBF - _ _ _ †	8	20.32
AAAPAPAA ◊ ** EPBV - _ _ _ †	12	30.48

1 Frame Door with Acrylic Insert, Hinged left or right, Corner

2 adjustable shelves

Width: 12-in. (30.48cm)

Height: 30-in. (76.20cm)



P/N	Hinged Left	Hinged Right	DEPTH	
			In.	Cm
Clear Acrylic Insert				
ADANA0AA ◊ BVEPBF - _ _ _ †		ADAO0AA ◊ BVEPBF - _ _ _ †	8	20.32
ADANA0AA ◊ BVEPBV - _ _ _ †		ADAO0AA ◊ BVEPBV - _ _ _ †	12	30.48
Tinted Acrylic Insert				
ADANAPAA ◊ BVEPBF - _ _ _ †		ADAOAPAA ◊ BVEPBF - _ _ _ †	8	20.32
ADANAPAA ◊ BVEPBV - _ _ _ †		ADAOAPAA ◊ BVEPBV - _ _ _ †	12	30.48

Important: These customer order requirements, in addition to other customer order requirements, must be satisfied prior to the beginning of manufacturing lead time:

◊Specify 1-digit Code to select type of drawer/door pull(s). See this Section, page 4 for drawer/door Pull Codes.

*Specify 2-digit Code to select Cabinet Width. See this Section, page 4 for Cabinet Width Codes.

†Specify 4-digit Code to select Laminate/Color. See this Section, pages 5 & 6 for Laminate/Color Codes.



SSCI laminated products are available in SSCI standard laminates, SSCI optional laminates, or Customer selected laminates.

For Product Information Call TOLL-FREE 1-800-323-7366 • (847) 537-9320 • Fax (847) 537-9061

Hours: 8:30am - 5:00pm CST Monday - Friday

Visit our website at: www.suburbansurgical.com

Finishing Components For Imperial 30-in. (76.20cm)H Upper Cabinets

Installation
against 1 wall

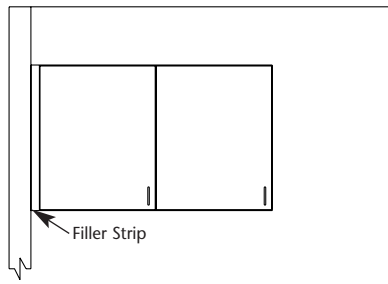

Installation
between 2 walls

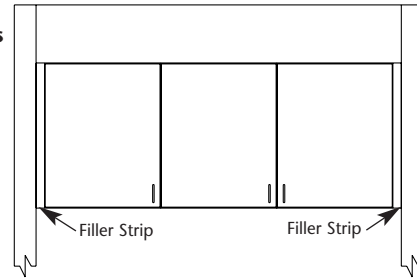

Filler Strips for Upper Cabinets

P/N	WIDE		HEIGHT		DEPTH	
	In.	Cm	In.	Cm	In.	Cm
DAODAEAAAAGEPAC-___†	1.75	4.45	30	76.20	.625	1.59
DAODAEAAAANEPAC-___†	3.50	8.89	30	76.20	.625	1.59

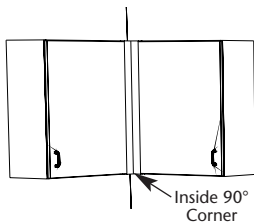

Inside 90° Corner for Upper Cabinets

P/N	WIDE		HEIGHT		DEPTH	
	In.	Cm	In.	Cm	In.	Cm
DAOAAEAAAIEPAI-___†	2.25	5.715	30	76.20	2.25	5.715

End Panels for Upper Cabinets

End Panel 30-in. (76.20cm) H; Upper Cabinets

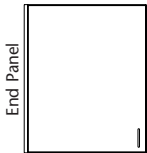

P/N	THICKNESS		HEIGHT		DEPTH	
	In.	Cm	In.	Cm	In.	Cm
DAOKAEAAAACEPBD-___†	.625	1.59	30	76.20	7.375	18.73
DAOKAEAAAACEPBF-___†	.625	1.59	30	76.20	8	20.32
DAOKAEAAAACEPBT-___†	.625	1.59	30	76.20	11.375	28.89
DAOKAEAAAACEPBV-___†	.625	1.59	30	76.20	12	30.48

End Panel Below 18-in. (45.72cm) H to 30-in. (76.20cm) H

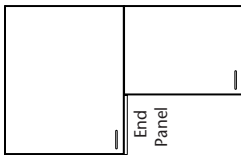

P/N	THICKNESS		HEIGHT		DEPTH	
	In.	Cm	In.	Cm	In.	Cm
DAOLAEAAAACBVBD-___†	.625	1.59	12	30.48	7.375	18.73
DAOLAEAAAACBVBF-___†	.625	1.59	12	30.48	8	20.32
DAOLAEAAAACBVBT-___†	.625	1.59	12	30.48	11.375	28.89
DAOLAEAAAACBVBV-___†	.625	1.59	12	30.48	12	30.48

Back Panels for Upper Cabinets

Back Panel Custom Widths; Upper 30-in. (76.20cm) H



P/N	WIDTH		HEIGHT		THICKNESS	
	In.	Cm	In.	Cm	In.	Cm
DAOMAEAAA **EPA-___†	As Required		30	76.20	.625	1.59

Important: These customer order requirements, in addition to other customer order requirements, must be satisfied prior to the beginning of manufacturing lead time:

*Specify 2-digit Code to select Cabinet Width. See this Section, page 4 for Cabinet Width Codes.

†Specify 4-digit Code to select Laminate/Color. See this Section, pages 5 & 6 for Laminate/Color Codes.



SSCI laminated products are available in SSCI standard laminates, SSCI optional laminates, or Customer selected laminates.

Imperial 36-in. (91.44cm)H Upper Cabinets

Open

2 adjustable shelves

Width: 12-in. to 42-in. (30.48cm to 106.68cm) in 3-in. (7.62cm) increments

Height: 36-in. (91.44cm)



P/N	DEPTH	
	In.	Cm
AAAAAAAA * FNBD - _ _ _ †	7.375	18.47
AAAAAAAA * FNBT - _ _ _ †	11.375	28.89

Open Corner

2 adjustable shelves

Width: 12-in. (30.48cm)

Height: 36-in. (91.44cm)



P/N	DEPTH	
	In.	Cm
ADAAAAAAAAABVFNBD - _ _ _ †	7.375	18.47
ADAAAAAAAAABVFNBT - _ _ _ †	11.375	28.89

1 Door Hinged left or right

2 adjustable shelves

Width: 12-in. to 24-in. (30.48cm to 60.96cm) in 3-in. (7.62cm) increments

Height: 36-in. (91.44cm)



P/N			DEPTH	
	Hinged Left	Hinged Right	In.	Cm
AAANAEAA ◊ ** FNBF - _ _ _ †	AAAOAEAA ◊ ** FNBF - _ _ _ †	8	20.32	
AAANAEAA ◊ ** FNBV - _ _ _ †	AAAOAEAA ◊ ** FNBV - _ _ _ †	12	30.48	

Pair of Hinged Doors

2 adjustable shelves

Width: 21-in. to 42-in. (53.34cm to 106.68cm) in 3-in. (7.62cm) increments

Height: 36-in. (91.44cm)



P/N	DEPTH	
	In.	Cm
AAAPAEAA ◊ ** FNBF - _ _ _ †	8	20.32
AAAPAEAA ◊ ** FNBV - _ _ _ †	12	30.48

1 Door Hinged left or right, Corner

2 adjustable shelves

Width: 12-in. (30.48cm)

Height: 36-in. (91.44cm)



P/N			DEPTH	
	Hinged Left	Hinged Right	In.	Cm
ADANAEAA ◊ BVFNBF - _ _ _ †	ADAOAEAA ◊ BVFNBF - _ _ _ †	8	20.32	
ADANAEAA ◊ BVFNBV - _ _ _ †	ADAOAEAA ◊ BVFNBV - _ _ _ †	12	30.48	

Important: These customer order requirements, in addition to other customer order requirements, must be satisfied prior to the beginning of manufacturing lead time:

◊ Specify 1-digit Code to select type of drawer/door pull(s). See this Section, page 4 for drawer/door Pull Codes.

* Specify 2-digit Code to select Cabinet Width. See this Section, page 4 for Cabinet Width Codes.

† Specify 4-digit Code to select Laminate/Color. See this Section, pages 5 & 6 for Laminate/Color Codes.



SSCI laminated products are available in SSCI standard laminates, SSCI optional laminates, or Customer selected laminates.

For Product Information Call TOLL-FREE 1-800-323-7366 • (847) 537-9320 • Fax (847) 537-9061

Hours: 8:30am - 5:00pm CST Monday - Friday

Visit our website at: www.suburbansurgical.com

Imperial 36-in. (91.44cm)H Upper Cabinets

Pair of Acrylic Sliding Doors

2 adjustable shelves

Width: 21-in. to 42-in. (53.34cm to 106.68cm) in 3-in. (7.62cm) increments

Height: 36-in. (91.44cm)



P/N	DEPTH	
	In.	Cm
Clear Acrylic Insert		
AAABAGAAA ** FNBD - _ _ _ _ †	7.375	18.47
AAABAGAAA ** FNBT - _ _ _ _ †	11.375	28.89
Tinted Acrylic Insert		
AAABAHAAA ** FNBD - _ _ _ _ †	7.375	18.47
AAABAHAAA ** FNBT - _ _ _ _ †	11.375	28.89

1 Frame Door with Acrylic Insert, Hinged left or right

2 adjustable shelves

Widths: 12-in. to 24-in. (30.48cm to 60.96cm) in 3-in. (7.62cm) increments

Height: 36-in. (91.44cm)



P/N		DEPTH	
		In.	Cm
Clear Acrylic Insert			
AAANAOAA ◊ ** FNBF - _ _ _ _ †	AAAOAOAA ◊ ** FNBF - _ _ _ _ †	8	20.32
AAANAOAA ◊ ** FNBFV - _ _ _ _ †	AAAOAOAA ◊ ** FNBFV - _ _ _ _ †	12	30.48
Tinted Acrylic Insert			
AAANAPAA ◊ ** FNBF - _ _ _ _ †	AAAOAPAA ◊ ** FNBF - _ _ _ _ †	8	20.32
AAANAPAA ◊ ** FNBFV - _ _ _ _ †	AAAOAPAA ◊ ** FNBFV - _ _ _ _ †	12	30.48

Pair of Framed Doors with Acrylic Insert, Hinged

2 adjustable shelves

Width: 21-in. to 42-in. (53.34cm to 106.68cm) in 3-in. (7.62cm) increments

Height: 36-in. (91.44cm)



P/N	DEPTH	
	In.	Cm
Clear Acrylic Insert		
AAAPAOAA ◊ ** FNBF - _ _ _ _ †	8	20.32
AAAPAOAA ◊ ** FNBFV - _ _ _ _ †	12	30.48
Tinted Acrylic Insert		
AAAPAPAA ◊ ** FNBF - _ _ _ _ †	8	20.32
AAAPAPAA ◊ ** FNBFV - _ _ _ _ †	12	30.48

1 Frame Door with Acrylic Insert, Hinged left or right, Corner

2 adjustable shelves

Width: 12-in. (30.48cm)

Height: 36-in. (91.44cm)



P/N		DEPTH	
		In.	Cm
Clear Acrylic Insert			
ADANAOAA ◊ BVFNBF - _ _ _ _ †	ADAOAOAA ◊ BVFNBF - _ _ _ _ †	8	20.32
ADANAOAA ◊ BVFNBFV - _ _ _ _ †	ADAOAOAA ◊ BVFNBFV - _ _ _ _ †	12	30.48
Tinted Acrylic Insert			
ADANAPAA ◊ BVFNBF - _ _ _ _ †	ADAOAPAA ◊ BVFNBF - _ _ _ _ †	8	20.32
ADANAPAA ◊ BVFNBFV - _ _ _ _ †	ADAOAPAA ◊ BVFNBFV - _ _ _ _ †	12	30.48

Important: These customer order requirements, in addition to other customer order requirements, must be satisfied prior to the beginning of manufacturing lead time:

◊ Specify 1-digit Code to select type of drawer/door pull(s). See this Section, page 4 for drawer/door Pull Codes.

* Specify 2-digit Code to select Cabinet Width. See this Section, page 4 for Cabinet Width Codes.

† Specify 4-digit Code to select Laminate/Color. See this Section, pages 5 & 6 for Laminate/Color Codes.



SSCI laminated products are available in SSCI standard laminates, SSCI optional laminates, or Customer selected laminates.

Finishing Components For Imperial 36-in. (91.44cm)H Upper Cabinets

**Installation
against 1 wall**

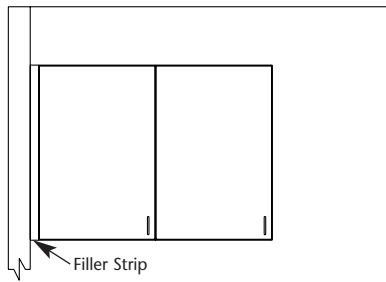

**Installation
between 2 walls**

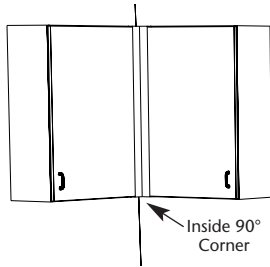
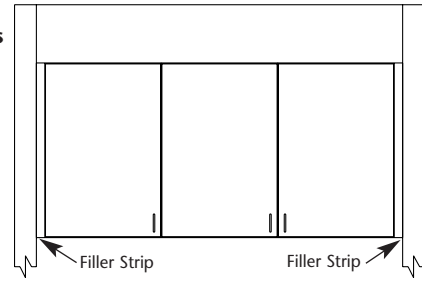

Filler Strips for Upper Cabinets

P/N	WIDE		HEIGHT		DEPTH	
	In.	Cm	In.	Cm	In.	Cm
DAODAEAAAAGFNAC-___†	1.75	4.45	36	91.44	.625	1.59
DAODAEAAAANFNAC-___†	3.50	8.89	36	91.44	.625	1.59

Inside 90° Corner for Upper Cabinets

P/N	WIDE		HEIGHT		DEPTH	
	In.	Cm	In.	Cm	In.	Cm
DAOAAEAAAIFNAI-___†	2.25	5.715	36	91.44	2.25	5.715

End Panels for Upper Cabinets

End Panel; 36-in. (91.44cm) H Upper Cabinets

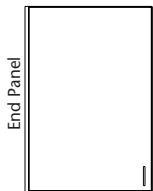

P/N	THICKNESS		HEIGHT		DEPTH	
	In.	Cm	In.	Cm	In.	Cm
DAOKAEAAAACFNBD-___†	.625	1.59	36	91.44	7.375	18.73
DAOKAEAAAACFNBF-___†	.625	1.59	36	91.44	8	20.32
DAOKAEAAAACFNBT-___†	.625	1.59	36	91.44	11.375	28.89
DAOKAEAAAACFNBV-___†	.625	1.59	36	91.44	12	30.48

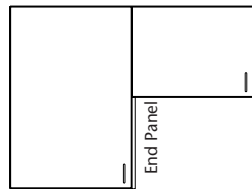

P/N	THICKNESS		HEIGHT		DEPTH	
	In.	Cm	In.	Cm	In.	Cm

End Panel; Below 18-in. (45.72cm) H to 36-in. (91.44cm) H

DAOLAEAAAACCTBD-___†	.625	1.59	18	45.72	7.375	18.73
DAOLAEAAAACCTBF-___†	.625	1.59	18	45.72	8	20.32
DAOLAEAAAACCTBT-___†	.625	1.59	18	45.72	11.375	28.89
DAOLAEAAAACCTBV-___†	.625	1.59	18	45.72	12	30.48

End Panel; Below 30-in. (76.20cm) H to 36-in. (91.44cm) H

DAOLAEAAAACAXBD-___†	.625	1.59	6	15.24	7.375	18.73
DAOLAEAAAACAXBF-___†	.625	1.59	6	15.24	8	20.32
DAOLAEAAAACAXBT-___†	.625	1.59	6	15.24	11.375	28.89
DAOLAEAAAACAXBV-___†	.625	1.59	6	15.24	12	30.48

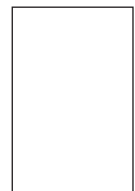

Back Panels for Upper Cabinets

Back Panel Custom Widths; Upper 36-in. (91.44cm) H

P/N	WIDTH		HEIGHT		THICKNESS	
	In.	Cm	In.	Cm	In.	Cm
DAOMAEAAA ** FNAA-___†	As Required		36	91.44	.625	1.59

Important: These customer order requirements, in addition to other customer order requirements, must be satisfied prior to the beginning of manufacturing lead time:

*Specify 2-digit Code to select Cabinet Width. See this Section, page 4 for Cabinet Width Codes.

†Specify 4-digit Code to select Laminate/Color. See this Section, pages 5 & 6 for Laminate/Color Codes.



SSCI laminated products are available in SSCI standard laminates, SSCI optional laminates, or Customer selected laminates.

For Product Information Call TOLL-FREE 1-800-323-7366 • (847) 537-9320 • Fax (847) 537-9061

Hours: 8:30am - 5:00pm CST Monday - Friday

Visit our website at: www.suburbansurgical.com

Imperial 30-in. (76.20cm) Pass-Thru Cabinets

Sliding Doors on both sides

2 adjustable shelves

Width: 21-in. to 42-in. (53.34cm to 106.68cm) in 3-in. (7.62cm) increments

Height: 30-in. (76.20cm)



P/N CLEAR ACRYLIC DOORS	TINTED ACRYLIC DOORS	DEPTH	
		In.	Cm
AGABAGAAA ** EPCR - _ _ _ _ †	AGABAHAAA ** EPCR - _ _ _ _ †	17.375	44.13

1 Door on both sides Hinged left or right

2 adjustable shelves

Width: 12-in. to 24-in. (30.48cm to 60.96cm) in 3-in. (7.62cm) increments

Height: 30-in.(76.20cm)



P/N HINGED LEFT	HINGED RIGHT	DEPTH	
		In.	Cm
AGANAEAA ◊ ** EPCV - _ _ _ _ †	AGAOAEAA ◊ ** EPCV - _ _ _ _ †	18.625	47.31

Pair of Hinged Doors on both sides

2 adjustable shelves

Width: 21-in. to 42-in. (53.34cm to 106.68cm) in 3-in. (7.62cm) increments

Height: 30-in.(76.20cm)



P/N	DEPTH	
	In.	Cm
AGAPAEAA ◊ ** EPCV - _ _ _ _ †	18.625	47.31

1 Framed Door with Acrylic Insert on both sides, Hinged left or right

2 adjustable shelves

Width: 12-in. to 24-in. (30.48cm to 60.96cm) in 3-in. (7.62cm) increments

Height: 30-in.(76.20cm)



P/N Hinged Left	Hinged Right	DEPTH	
		In.	Cm
Clear Acrylic Insert			
AGANAOAA ◊ ** EPCV - _ _ _ _ †	AGAOAOAA ◊ ** EPCV - _ _ _ _ †	18.625	47.31
Tinted Acrylic Insert			
AGANAPAA ◊ ** EPCV - _ _ _ _ †	AGAOAPAA ◊ ** EPCV - _ _ _ _ †	18.625	47.31

Pair of Framed Doors with Acrylic Insert on both sides, Hinged

2 adjustable shelves

Width: 21-in. to 42-in. (53.34cm to 106.68cm) in 3-in. (7.62cm) increments

Height: 30-in.(76.20cm)



P/N	DEPTH	
	In.	Cm
Clear Acrylic Insert		
AGAPAOAA ◊ ** EPCV - _ _ _ _ †	18.625	47.31
Tinted Acrylic Insert		
AGAPAPAA ◊ ** EPCV - _ _ _ _ †	18.625	47.31

Important: These customer order requirements, in addition to other customer order requirements, must be satisfied prior to the beginning of manufacturing lead time:

◊ Specify 1-digit Code to select type of drawer/door pull(s). See this Section, page 4 for drawer/door Pull Codes.

* Specify 2-digit Code to select Cabinet Width. See this Section, page 4 for Cabinet Width Codes.

† Specify 4-digit Code to select Laminate/Color. See this Section, pages 5 & 6 for Laminate/Color Codes.



SSCI laminated products are available in SSCI standard laminates, SSCI optional laminates, or Customer selected laminates.

Finishing Components for Imperial 30-in. (76.20cm) H Pass-Thru Upper Cabinets

Installation against 1 wall

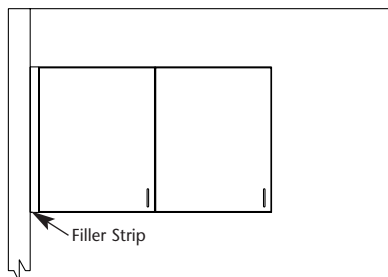

Installation between 2 walls

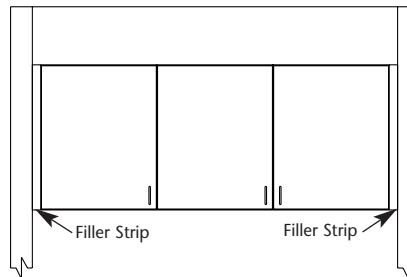

Filler Strips for Pass-Thru Upper Cabinets

P/N	WIDE		HEIGHT		DEPTH	
	In.	Cm	In.	Cm	In.	Cm
DAODAEAAAAGEPAC-___†	1.75	4.45	30	76.20	.625	1.59
DAODAEAAAANEPAC-___†	3.50	8.89	30	76.20	.625	1.59

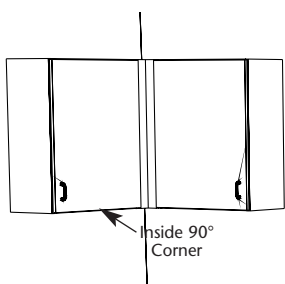

Inside 90° Corner for Pass-Thru Upper Cabinets

P/N	WIDE		HEIGHT		DEPTH	
	In.	Cm	In.	Cm	In.	Cm
DAOAAEAAAIEPAI-___†	2.25	5.715	30	76.20	2.25	5.715

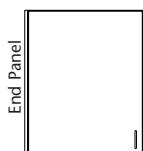

End Panels for Pass-Thru Upper Cabinets

End Panel; 30-in. (76.20cm) H to Pass-Thru Upper Cabinets

P/N	THICKNESS		HEIGHT		DEPTH	
	In.	Cm	In.	Cm	In.	Cm
DAOKAEAAAACEPBD-___†	.625	1.59	30	76.20	7.375	18.73
DAOKAEAAAACEPBF-___†	.625	1.59	30	76.20	8	20.32
DAOKAEAAAACEPBT-___†	.625	1.59	30	76.20	11.375	28.89
DAOKAEAAAACEPBV-___†	.625	1.59	30	76.20	12	30.48

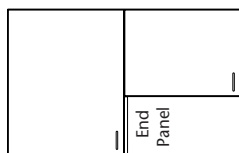

End Panel; Below 18-in. (45.72cm) H to 30-in. (76.20cm) H

P/N	THICKNESS		HEIGHT		DEPTH	
	In.	Cm	In.	Cm	In.	Cm
DAOLAEAAAACBVD-___†	.625	1.59	12	30.48	7.375	18.73
DAOLAEAAAACBVF-___†	.625	1.59	12	30.48	8	20.32
DAOLAEAAAACBVT-___†	.625	1.59	12	30.48	11.375	28.89
DAOLAEAAAACBVBV-___†	.625	1.59	12	30.48	12	30.48

Important: These customer order requirements, in addition to other customer order requirements, must be satisfied prior to the beginning of manufacturing lead time:

*Specify 2-digit Code to select Cabinet Width. See this Section, page 4 for Cabinet Width Codes.

†Specify 4-digit Code to select Laminate/Color. See this Section, pages 5 & 6 for Laminate/Color Codes.



SSCI laminated products are available in SSCI standard laminates, SSCI optional laminates, or Customer selected laminates.

For Product Information Call TOLL-FREE 1-800-323-7366 • (847) 537-9320 • Fax (847) 537-9061

Hours: 8:30am - 5:00pm CST Monday - Friday

Visit our website at: www.suburbansurgical.com

Imperial 36-in. (91.44cm) Pass-Thru Upper Cabinets

Sliding Doors on both sides

2 adjustable shelves

Width: 21-in. to 42-in. (53.34cm to 106.68cm) in 3-in. (7.62cm) increments

Height: 36-in. (91.44cm)



P/N CLEAR ACRYLIC DOORS	TINTED ACRYLIC DOORS	DEPTH	
		In.	Cm
AGABAGAAA ** FNCR - _ _ _ _ †	AGABAHAAA ** FNCR - _ _ _ _ †	17.375	44.13

1 Door on both sides Hinged left or right

2 adjustable shelves

Width: 12-in. to 24-in. (30.48cm to 60.96cm) in 3-in. (7.62cm) increments

Height: 36-in. (91.44cm)



P/N HINGED LEFT	HINGED RIGHT	DEPTH	
		In.	Cm
AGANAEAA ◊ ** FNCV - _ _ _ _ †	AGAOAEAA ◊ ** FNCV - _ _ _ _ †	18.625	47.31

Pair of Hinged Doors on both sides

2 adjustable shelves

Width: 21-in. to 42-in. (53.34cm to 106.68cm) in 3-in. (7.62cm) increments

Height: 36-in. (91.44cm)



P/N	DEPTH	
	In.	Cm
AGAPAEAA ◊ ** FNCV - _ _ _ _ †	18.625	47.31

1 Framed Door with Acrylic Insert on both sides, Hinged left or right

2 adjustable shelves

Width: 12-in. to 24-in. (30.48cm to 60.96cm) in 3-in. (7.62cm) increments

Height: 36-in. (91.44cm)



P/N Hinged Left	Hinged Right	DEPTH	
		In.	Cm
Clear Acrylic Insert			
AGANAOAA ◊ ** FNCV - _ _ _ _ †	AGAOAOAA ◊ ** FNCV - _ _ _ _ †	18.625	47.31
Tinted Acrylic Insert			
AGANAPAA ◊ ** FNCV - _ _ _ _ †	AGAOAPAA ◊ ** FNCV - _ _ _ _ †	18.625	47.31

Pair of Framed Doors with Acrylic Insert on both sides, Hinged

2 adjustable shelves

Width: 21-in. to 42-in. (53.34cm to 106.68cm) in 3-in. (7.62cm) increments

Height: 36-in. (91.44cm)



P/N	DEPTH	
	In.	Cm
Clear Acrylic Insert		
AGAPAOAA ◊ ** FNCV - _ _ _ _ †	18.625	47.31
Tinted Acrylic Insert		
AGAPAPAA ◊ ** FNCV - _ _ _ _ †	18.625	47.31

Important: These customer order requirements, in addition to other customer order requirements, must be satisfied prior to the beginning of manufacturing lead time:

◊ Specify 1-digit Code to select type of drawer/door pull(s). See this Section, page 4 for drawer/door Pull Codes.

* Specify 2-digit Code to select Cabinet Width. See this Section, page 4 for Cabinet Width Codes.

† Specify 4-digit Code to select Laminate/Color. See this Section, pages 5 & 6 for Laminate/Color Codes.



SSCI laminated products are available in SSCI standard laminates, SSCI optional laminates, or Customer selected laminates.

Finishing Components for Imperial 36-in. (91.44cm) H Pass-Thru Upper Cabinets

Installation against 1 wall

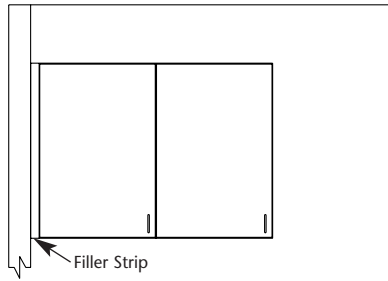

Installation between 2 walls

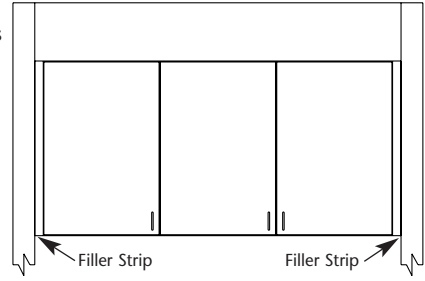

Filler Strips for Pass-Thru Upper Cabinets

P/N	WIDE		HEIGHT		DEPTH	
	In.	Cm	In.	Cm	In.	Cm
DAODAEAAAAGFNAC-___†	1.75	4.45	36	91.44	.625	1.59
DAODAEAAAANFNAC-___†	3.50	8.89	36	91.44	.625	1.59

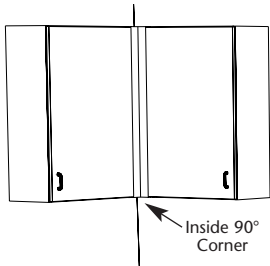

Inside 90° Corner for Pass-Thru Upper Cabinets

P/N	WIDE		HEIGHT		DEPTH	
	In.	Cm	In.	Cm	In.	Cm
DAOAEEAAAIFNAI-___†	2.25	5.715	36	91.44	2.25	5.715

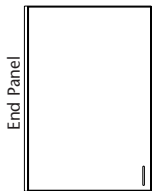

End Panels for Pass-Thru Upper Cabinets

End Panel; 36-in. (91.44cm) H to Pass-Thru Upper Cabinets

P/N	THICKNESS		HEIGHT		DEPTH	
	In.	Cm	In.	Cm	In.	Cm
DAOKAEAAAACFNBD-___†	.625	1.59	36	91.44	7.375	18.73
DAOKAEAAAACFNBF-___†	.625	1.59	36	91.44	8	20.32
DAOKAEAAAACFNBT-___†	.625	1.59	36	91.44	11.375	28.89
DAOKAEAAAACFNBV-___†	.625	1.59	36	91.44	12	30.48

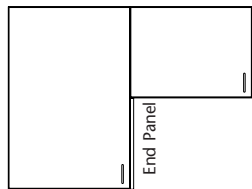

P/N	THICKNESS		HEIGHT		DEPTH	
	In.	Cm	In.	Cm	In.	Cm
End Panel; Below 18-in. (45.72cm) H to 36-in. (91.44cm) H						
DAOLAEAAAACCTBD-___†	.625	1.59	18	45.72	7.375	18.73
DAOLAEAAAACCTBF-___†	.625	1.59	18	45.72	8	20.32
DAOLAEAAAACCTBT-___†	.625	1.59	18	45.72	11.375	28.89
DAOLAEAAAACCTBV-___†	.625	1.59	18	45.72	12	30.48
End Panel; Below 30-in. (76.20cm) H to 36-in. (91.44cm) H						
DAOLAEAAAACXBD-___†	.625	1.59	6	15.24	7.375	18.73
DAOLAEAAAACXBF-___†	.625	1.59	6	15.24	8	20.32
DAOLAEAAAACXBT-___†	.625	1.59	6	15.24	11.375	28.89
DAOLAEAAAACXBV-___†	.625	1.59	6	15.24	12	30.48

Important: These customer order requirements, in addition to other customer order requirements, must be satisfied prior to the beginning of manufacturing lead time:

*Specify 2-digit Code to select Cabinet Width. See this Section, page 4 for Cabinet Width Codes.

†Specify 4-digit Code to select Laminate/Color. See this Section, pages 5 & 6 for Laminate/Color Codes.



SSCI laminated products are available in SSCI standard laminates, SSCI optional laminates, or Customer selected laminates.

For Product Information Call TOLL-FREE 1-800-323-7366 • (847) 537-9320 • Fax (847) 537-9061

Hours: 8:30am - 5:00pm CST Monday - Friday

Visit our website at: www.suburbansurgical.com

Imperial Desk Undercounter Cabinets



1 Desk Drawer

Width: 12-in. to 36-in. (30.48cm to 91.44cm) in 3-in. (7.62cm) increments
Height: 5.25-in. (13.34cm)
Depth: 18-in. or 24-in. (45.72cm or 60.96cm)

P/N	DEPTH	
	In.	Cm
ALBBAEAA ◊ ** AUCT-___ †	18	45.72
ALBBAEAA ◊ ** AUDR-___ †	24	60.96

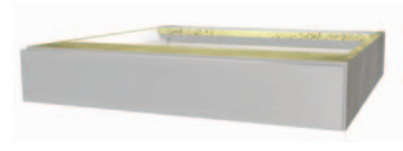

1 Keyboard Drop Front Drawer

Width: 18-in. to 24-in. (45.72cm to 60.96cm) in 3-in. (7.62cm) increments
Height: 5.25-in. (13.34cm)
Depth: 18-in. or 24-in. (45.72cm or 60.96cm)

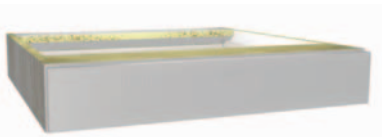

P/N	DEPTH	
	In.	Cm
ALBKAEAA ◊ ** AUCT-___ †	18	45.72
ALBKAEAA ◊ ** AUDR-___ †	24	60.96

Important: These customer order requirements, in addition to other customer order requirements, must be satisfied prior to the beginning of manufacturing lead time:

◊ Specify 1-digit Code to select type of drawer/door pull(s). See this Section, page 4 for drawer/door Pull Codes.

* Specify 2-digit Code to select Cabinet Width. See this Section, page 4 for Cabinet Width Codes.

† Specify 4-digit Code to select Laminate/Color. See this Section, pages 5 & 6 for Laminate/Color Codes.



SSCI laminated products are available in SSCI standard laminates, SSCI optional laminates, or Customer selected laminates.

Finishing Components for Imperial Desk Undercounter Cabinets

Installation against 1 wall

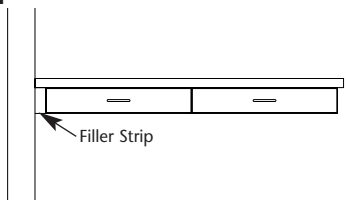

Installation between 2 walls

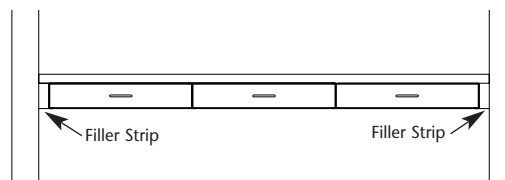

Filler Strips for Desk Cabinets

P/N	WIDE		HEIGHT		DEPTH	
	In.	Cm	In.	Cm	In.	Cm
DLODAEAAAAGAUAC-___†	1.75	4.45	5.25	13.34	.625	1.59
DLODAEAAAANAUAC-___†	3.50	8.89	5.25	13.34	.625	1.59

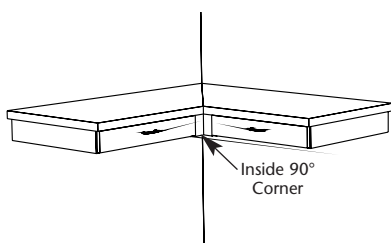

Inside 90° Corners for Desk Cabinets

P/N	WIDE		HEIGHT		DEPTH	
	In.	Cm	In.	Cm	In.	Cm
DLOAAEAAAIAUAI-___†	2.25	5.715	5.25	13.34	2.25	5.715

End Panels for Desk Cabinets

End Panel; 5.250-in. (13.34cm) H Desk

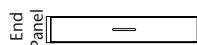

P/N	THICKNESS		HEIGHT		DEPTH	
	In.	Cm	In.	Cm	In.	Cm
DLOKAEAAAACAUCR-___†	.625	1.59	5.25	13.34	17.375	44.13
DLOKAEAAAACAUCT-___†	.625	1.59	5.25	13.34	18	45.72
DLOKAEAAAACAUDP-___†	.625	1.59	5.25	13.34	23.375	59.37
DLOKAEAAAACAUDR-___†	.625	1.59	5.25	13.34	24	60.96

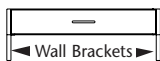

Wall Brackets for Desk Cabinets

Wall bracket; Desk

P/N	WIDE		HEIGHT		DEPTH	
	In.	Cm	In.	Cm	In.	Cm
DLOPAEAAAACBHCT-___†	.625	1.59	8.50	21.59	18	45.72
DLOPAEAAAACBHDR-___†	.625	1.59	8.50	21.59	24	60.96



Back Panels for Desk Cabinets

Back Panel Custom Widths; Desk 5.250-in. (13.34cm) H

P/N	WIDTH		HEIGHT		THICKNESS	
	In.	Cm	In.	Cm	In.	Cm
DLOMAEAAA ** AUAA-___†	As Required		5.25	13.34	.625	1.59

Important: These customer order requirements, in addition to other customer order requirements, must be satisfied prior to the beginning of manufacturing lead time:

*Specify 2-digit Code to select Cabinet Width. See this Section, page 4 for Cabinet Width Codes.

†Specify 4-digit Code to select Laminate/Color. See this Section, pages 5 & 6 for Laminate/Color Codes.



SSCI laminated products are available in SSCI standard laminates, SSCI optional laminates, or Customer selected laminates.

For Product Information Call TOLL-FREE 1-800-323-7366 • (847) 537-9320 • Fax (847) 537-9061

Hours: 8:30am - 5:00pm CST Monday - Friday

Visit our website at: www.suburbansurgical.com

Imperial Wall-Mount Undercounter Cabinets



Wall-Mount

Undercounter Cabinets may be placed on the wall at the optimum height for the task at hand. Open area underneath allows you to quickly clean the floor in exam and treatment rooms. Our complete selection of Cabinet styles includes a knee drawer for an easy-to-assemble desk.

Open

1 adjustable shelf

Width: 12-in. to 42-in. (30.48cm to 106.68cm) in 3-in. (7.62cm) increments

Height: 19.125-in. (48.58cm)

Depth: 18-in. or 24-in. (45.72cm or 60.96cm)

P/N	DEPTH	
	In.	Cm
ALAAAAAA * _ CYCR- _ _ _ †	18	45.72
ALAAAAAA * _ CYDP- _ _ _ †	24	60.96



Open Corner

1 adjustable shelf

Width: 12-in. (30.48cm)

Height: 19.125-in. (48.58cm)

Depth: 17.375-in. or 23.375-in. (44.13cm or 59.37cm)



P/N	DEPTH	
	In.	Cm
AOAAAAABVCYCR- _ _ _ †	17.375	44.13
AOAAAAABVCYDP- _ _ _ †	23.375	59.37

Important: These customer order requirements, in addition to other customer order requirements, must be satisfied prior to the beginning of manufacturing lead time:

*Specify 2-digit Code to select Cabinet Width. See this Section, page 4 for Cabinet Width Codes.

†Specify 4-digit Code to select Laminate/Color. See this Section, pages 5 & 6 for Laminate/Color Codes.



SSCI laminated products are available in SSCI standard laminates, SSCI optional laminates, or Customer selected laminates.

Imperial Wall-Mount Undercounter Cabinets

1 Door Hinged left or right

1 adjustable shelf
Width: 12-in. to 24-in. (30.48cm to 60.96cm) in 3-in. (7.62cm) increments
Height: 19.125-in. (48.58cm)
Depth: 18-in. or 24-in. (45.72cm or 60.96cm)



P/N HINGED LEFT	HINGED RIGHT	DEPTH	
		In.	Cm
ALANAEAA ◊ ** CYCT - _ _ _ †	ALAOAEAA ◊ ** CYCT - _ _ _ †	18	45.72
ALANAEAA ◊ ** CYDR - _ _ _ †	ALAOAEAA ◊ ** CYDR - _ _ _ †	24	60.96

Pair of Hinged Doors



1 adjustable shelf
Width: 21-in. to 42-in. (53.34cm to 106.68cm) in 3-in. (7.62cm) increments
Height: 19.125-in. (48.58cm)
Depth: 18-in. or 24-in. (45.72cm or 60.96cm)

P/N	DEPTH	
	In.	Cm
ALAPAEAA ◊ ** CYCT- _ _ _ †	18	45.72
ALAPAEAA ◊ ** CYDR- _ _ _ †	24	60.96

1 Door Hinged left or right, Corner

1 adjustable shelf
Width: 12-in. (30.48cm)
Height: 19.125-in. (48.58cm)
Depth: 18-in. or 24-in. (45.72cm or 60.96cm)



P/N HINGED LEFT	HINGED RIGHT	DEPTH	
		In.	Cm
AOANAEAA ◊ BVCYCT - _ _ _ †	AOAOAEAA ◊ BVCYCT - _ _ _ †	18	45.72
AOANAEAA ◊ BVCYDR - _ _ _ †	AOAOAEAA ◊ BVCYDR - _ _ _ †	24	60.96

3 "C" Drawers



Width: 12-in. to 36-in. (30.48cm to 91.44cm) in 3-in. (7.62cm) increments
Height: 19.125-in. (48.58cm)
Depth: 18-in. or 24-in. (45.72cm or 60.96cm)

P/N	DEPTH	
	In.	Cm
ALCAAEAA ◊ ** CYCT- _ _ _ †	18	45.72
ALCAAEAA ◊ ** CYDR- _ _ _ †	24	60.96

Important: These customer order requirements, in addition to other customer order requirements, must be satisfied prior to the beginning of manufacturing lead time:
◊ Specify 1-digit Code to select type of drawer/door pull(s). See this Section, page 4 for drawer/door Pull Codes.
* Specify 2-digit Code to select Cabinet Width. See this Section, page 4 for Cabinet Width Codes.
† Specify 4-digit Code to select Laminate/Color. See this Section, pages 5 & 6 for Laminate/Color Codes.



SSCI laminated products are available in SSCI standard laminates, SSCI optional laminates, or Customer selected laminates.

Finishing Components For Imperial Wall-Mount Undercounter Cabinets

Installation against 1 wall

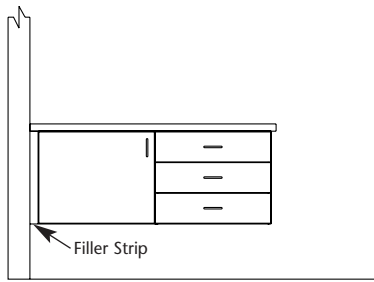

Installation between 2 walls

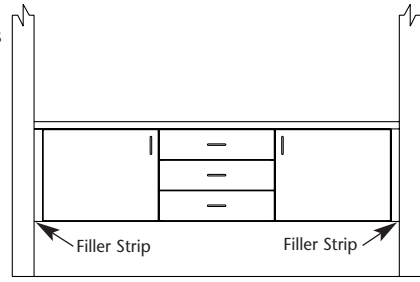

Filler Strips for Wall-Mount Cabinets

P/N	WIDE		HEIGHT		DEPTH	
	In.	Cm	In.	Cm	In.	Cm
DLODAEAAAAGCYAC-___†	1.75	4.45	19.125	48.58	.625	1.59
DLODAEAAAANCYAC-___†	3.50	8.89	19.125	48.58	.625	1.59

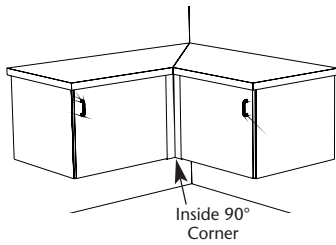

Inside 90° Corner for Wall-Mount Cabinets

P/N	WIDE		HEIGHT		DEPTH	
	In.	Cm	In.	Cm	In.	Cm
DLOAAEAAAICYAI-___†	2.25	5.715	19.125	48.90	2.25	5.715

End Panels for Wall-Mount Cabinets

End Panel; 19.125-in. (48.90cm) H



P/N	THICKNESS		HEIGHT		DEPTH	
	In.	Cm	In.	Cm	In.	Cm
DLOKAEAAAACCYCR-___†	.625	1.59	19.125	48.90	17.375	44.13
DLOKAEAAAACCYCT-___†	.625	1.59	19.125	48.90	18	45.72
DLOKAEAAAACCYDP-___†	.625	1.59	19.125	48.90	23.375	59.37
DLOKAEAAAACCYDR-___†	.625	1.59	19.125	48.90	24	60.96

End Panel; Below Desk 5.25-in. (13.34cm) to Wall-Mount 19.125-in. (48.58cm)

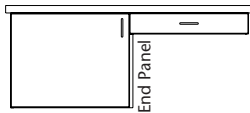

P/N	THICKNESS		HEIGHT		DEPTH	
	In.	Cm	In.	Cm	In.	Cm
DLOLAEAAAACDCR-___†	.625	1.59	13.875	35.24	17.375	44.13
DLOLAEAAAACDCT-___†	.625	1.59	13.875	35.24	18	45.72
DLOLAEAAAACDDP-___†	.625	1.59	13.875	35.24	23.375	59.37
DLOLAEAAAACDDR-___†	.625	1.59	13.875	35.24	24	60.96

Back Panels for Wall-Mount Undercounter Cabinets

Back Panel Custom Widths



P/N	WIDTH		HEIGHT		THICKNESS	
	In.	Cm	In.	Cm	In.	Cm
DLOMAEAAA ** CYAA-___†	As Required		19.125	35.88	.625	1.59

Important: These customer order requirements, in addition to other customer order requirements, must be satisfied prior to the beginning of manufacturing lead time:

*Specify 2-digit Code to select Cabinet Width. See this Section, page 4 for Cabinet Width Codes.

†Specify 4-digit Code to select Laminate/Color. See this Section, pages 5 & 6 for Laminate/Color Codes.



SSCI laminated products are available in SSCI standard laminates, SSCI optional laminates, or Customer selected laminates.

Imperial Undercounter Reception Height Cabinets



Reception Height

Undercounter Cabinets are available in a wide variety of cupboard/drawer combinations. Reception Height Cabinetry is used for areas where your staff will be sitting; such as reception and clerical areas.

Our Design Service can help with area layouts, cabinet sizes and other decisions to help you maximize the efficiency of your staff and facility, and create a professional presentation.

Imperial Undercounter Reception Height Cabinets

Open

1 adjustable shelf

Width: 12-in. to 42-in. (30.48cm to 106.68cm) in 3-in. (7.62cm) increments

Height: 28.50-in. (72.39cm)

Depth: 17.375-in. or 23.375-in. (44.13cm or 59.37cm)



P/N	DEPTH	
	In.	Cm
ARAAAAAA ** EJCR - _ _ _ _ †	17.375	44.13
ARAAAAAA ** EJDP - _ _ _ _ †	23.375	59.37

Open Corner

1 adjustable shelf

Width: 12-in. (30.48cm)

Height: 28.50-in. (72.39cm)

Depth: 17.375-in. or 23.375-in. (44.13cm or 59.37cm)



P/N	DEPTH	
	In.	Cm
AUAAAAAA ABVEJCR - _ _ _ _ †	17.375	44.13
AUAAAAAA ABVEJDP - _ _ _ _ †	23.375	59.37

1 Door Hinged left or right

1 adjustable shelf

Width: 12-in. to 24-in. (30.48cm to 60.96cm) in 3-in. (7.62cm) increments

Height: 28.50-in. (72.39cm)

Depth: 18-in. or 24-in. (45.72cm or 60.96cm)

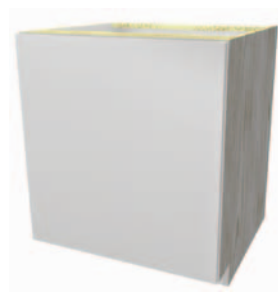

P/N	Hinged Left	Hinged Right	DEPTH	
			In.	Cm
ARANAEEA ◊ ** EJCT - _ _ _ _ †	ARAOAEEA ◊ ** EJCT - _ _ _ _ †	18	45.72	
ARANAEEA ◊ ** EJDR - _ _ _ _ †	ARAOAEEA ◊ ** EJDR - _ _ _ _ †	24	60.96	

Pair of Hinged Doors

1 adjustable shelf

Width: 21-in. to 42-in. (53.34cm to 106.68cm) in 3-in. (7.62cm) increments

Height: 28.50-in. (72.39cm)

Depth: 18-in. or 24-in. (45.72cm or 60.96cm)



P/N	DEPTH	
	In.	Cm
ARAPAEAA ◊ ** EJCT - _ _ _ _ †	18	45.72
ARAPAEAA ◊ ** EJDR - _ _ _ _ †	24	60.96

Important: These customer order requirements, in addition to other customer order requirements, must be satisfied prior to the beginning of manufacturing lead time:

◊ Specify 1-digit Code to select type of drawer/door pull(s). See this Section, page 4 for drawer/door Pull Codes.

* Specify 2-digit Code to select Cabinet Width. See this Section, page 4 for Cabinet Width Codes.

† Specify 4-digit Code to select Laminate/Color. See this Section, pages 5 & 6 for Laminate/Color Codes.



SSCI laminated products are available in SSCI standard laminates, SSCI optional laminates, or Customer selected laminates.

Imperial Undercounter Reception Height Cabinets

1 Door Hinged left or right, Corner

1 adjustable shelf

Width: 12-in. (30.48cm)

Height: 28.50-in.(72.39cm)

Depth: 18-in. or 24-in. (45.72cm or 60.96cm)



P/N	Hinged Left	Hinged Right	DEPTH	
			In.	Cm
AUANAEAA	∩ BVEJCT - _ _ _ †	AUAOAEAA ∩ BVEJCT - _ _ _ †	18	45.72
AUANAEAA	∩ BVEJDR - _ _ _ †	AUAOAEAA ∩ BVEJDR - _ _ _ †	24	60.96

"C" Drawer or Sink Front, 1 Door Hinged left or right

Width: 12-in. to 24-in. (30.48cm to 60.96cm) in 3-in. (7.62cm) increments

Height: 28.50-in. (72.39cm)

Depth: 18-in. or 24-in. (45.72cm or 60.96cm)



P/N	Hinged Left	Hinged Right	DEPTH	
			In.	Cm
"C" Drawer; 1 adjustable shelf				
ARDNAEAA	∩ ** EJCT - _ _ _ †	ARDOAEAA ∩ ** EJCT - _ _ _ †	18	45.72
ARDNAEAA	∩ ** EJDR - _ _ _ †	ARDOAEAA ∩ ** EJDR - _ _ _ †	24	60.96
"C" Sink Front				
ARFNAEAA	∩ ** EJCT - _ _ _ †	ARFOAEAA ∩ ** EJCT - _ _ _ †	18	45.72
ARFNAEAA	∩ ** EJDR - _ _ _ †	ARFOAEAA ∩ ** EJDR - _ _ _ †	24	60.96

"C" Drawer or Sink Front, Pair of Hinged Doors

Width: 21-in. to 36-in. (53.34cm to 91.44cm) in 3-in. (7.62cm) increments

Height: 28.50-in.(72.39cm)

Depth: 18-in. or 24-in. (45.72cm or 60.96cm)



P/N	DEPTH	
	In.	Cm
"C" Drawer; 1 adjustable shelf		
ARDRAEAA	∩ ** EJCT - _ _ _ †	18 45.72
ARDRAEAA	∩ ** EJDR - _ _ _ †	24 60.96
"C" Sink Front		
ARFRAEAA	∩ ** EJCT - _ _ _ †	18 45.72
ARFRAEAA	∩ ** EJDR - _ _ _ †	24 60.96

"D" Drawer or Sink Front, 1 Door Hinged left or right

Width: 12-in. to 24-in. (30.48cm to 60.96cm) in 3-in. (7.62cm) increments

Height: 28.50-in. (72.39cm)

Depth: 18-in. or 24-in. (45.72cm or 60.96cm)



P/N	Hinged Left	Hinged Right	DEPTH	
			In.	Cm
"D" Drawer; 1 adjustable shelf				
ARDPAEAA	∩ ** EJCT - _ _ _ †	ARDQAEAA ∩ ** EJCT - _ _ _ †	18	45.72
ARDPAEAA	∩ ** EJDR - _ _ _ †	ARDQAEAA ∩ ** EJDR - _ _ _ †	24	60.96
"D" Sink Front				
ARFPAEAA	∩ ** EJCT - _ _ _ †	ARFQAEAA ∩ ** EJCT - _ _ _ †	18	45.72
ARFPAEAA	∩ ** EJDR - _ _ _ †	ARFQAEAA ∩ ** EJDR - _ _ _ †	24	60.96

Important: These customer order requirements, in addition to other customer order requirements, must be satisfied prior to the beginning of manufacturing lead time:

∩ Specify 1-digit Code to select type of drawer/door pull(s). See this Section, page 4 for drawer/door Pull Codes.

* Specify 2-digit Code to select Cabinet Width. See this Section, page 4 for Cabinet Width Codes.

† Specify 4-digit Code to select Laminate/Color. See this Section, pages 5 & 6 for Laminate/Color Codes.



SSCI laminated products are available in SSCI standard laminates, SSCI optional laminates, or Customer selected laminates.

For Product Information Call TOLL-FREE 1-800-323-7366 • (847) 537-9320 • Fax (847) 537-9061

Hours: 8:30am - 5:00pm CST Monday - Friday

Visit our website at: www.suburbansurgical.com

Section 19

Imperial Undercounter Reception Height Cabinets

"D" Drawer or Sink Front, Pair of Hinged Doors

Width: 21-in. to 36-in. (53.34cm to 91.44cm) in 3-in. (7.62cm) increments
Height: 28.50-in. (72.39cm)
Depth: 18-in. or 24-in. (45.72cm or 60.96cm)

P/N	DEPTH	
	In.	Cm
"D" Drawer; 1 adjustable shelf		
ARDSAEAA ◊ * * EJCT - _ _ _ _ †	18	45.72
ARDSAEAA ◊ * * EJDR - _ _ _ _ †	24	60.96
"D" Sink Front		
ARFSAEAA ◊ * * EJCT - _ _ _ _ †	18	45.72
ARFSAEAA ◊ * * EJDR - _ _ _ _ †	24	60.96



2 "I" File Drawers

Width: 15-in. or 18-in. (38.10cm or 45.72cm)
Height: 28.50-in. (72.39cm)
Depth: 18-in. or 24-in. (45.72cm or 60.96cm)

P/N	DEPTH	
	In.	Cm
ARBNAEAA ◊ * * EJCT - _ _ _ _ †	18	45.72
ARBNAEAA ◊ * * EJDR - _ _ _ _ †	24	60.96

1 "C", 1 "E", 1 "F" Drawers

Width: 12-in. to 36-in. (30.48cm to 91.44cm) in 3-in. (7.62cm) increments
Height: 28.50-in. (72.39cm)
Depth: 18-in. or 24-in. (45.72cm or 60.96cm)

P/N	DEPTH	
	In.	Cm
ARCCAEEA ◊ * * EJCT - _ _ _ _ †	18	45.72
ARCCAEEA ◊ * * EJDR - _ _ _ _ †	24	60.96



2 "C" Drawers, 1 "I" File Drawer

Width: 15-in. or 18-in. (38.10cm or 45.72cm)
Height: 28.50-in. (72.39cm)
Depth: 18-in. or 24-in. (45.72cm or 60.96cm)

P/N	DEPTH	
	In.	Cm
ARCDAAEA ◊ * * EJCT - _ _ _ _ †	18	45.72
ARCDAAEA ◊ * * EJDR - _ _ _ _ †	24	60.96

Important: These customer order requirements, in addition to other customer order requirements, must be satisfied prior to the beginning of manufacturing lead time:

◊ Specify 1-digit Code to select type of drawer/door pull(s). See this Section, page 4 for drawer/door Pull Codes.

* Specify 2-digit Code to select Cabinet Width. See this Section, page 4 for Cabinet Width Codes.

† Specify 4-digit Code to select Laminate/Color. See this Section, pages 5 & 6 for Laminate/Color Codes.



SSCI laminated products are available in SSCI standard laminates, SSCI optional laminates, or Customer selected laminates.

Imperial Undercounter Reception Height Cabinets

3 "L" Drawers

Width: 12-in. to 36-in. (30.48cm to 91.44cm) in 3-in. (7.62cm) increments

Height: 28.50-in. (72.39cm)

Depth: 18-in. or 24-in. (45.72cm or 60.96cm)

P/N	DEPTH	
	In.	Cm
ARCFEAEEA ◊ ** EJCT - ___ †	18	45.72
ARCFEAEEA ◊ ** EJDR - ___ †	24	60.96



4 "C" Drawers

Width: 12-in. to 36-in. (30.48cm to 91.44cm) in 3-in. (7.62cm) increments

Height: 28.50-in. (72.39cm)

Depth: 18-in. or 24-in. (45.72cm or 60.96cm)

P/N	DEPTH	
	In.	Cm
ARCNAEEA ◊ ** EJCT - ___ †	18	45.72
ARCNAEEA ◊ ** EJDR - ___ †	24	60.96

2 "B" + 2 "D" Drawers

Width: 12-in. to 36-in. (30.48cm to 91.44cm) in 3-in. (7.62cm) increments

Height: 28.50-in. (72.39cm)

Depth: 18-in. or 24-in. (45.72cm or 60.96cm)

P/N	DEPTH	
	In.	Cm
ARCRAEEA ◊ ** EJCT - ___ †	18	45.72
ARCRAEEA ◊ ** EJDR - ___ †	24	60.96



Important: These customer order requirements, in addition to other customer order requirements, must be satisfied prior to the beginning of manufacturing lead time:

◊ Specify 1-digit Code to select type of drawer/door pull(s). See this Section, page 4 for drawer/door Pull Codes.

* Specify 2-digit Code to select Cabinet Width. See this Section, page 4 for Cabinet Width Codes.

† Specify 4-digit Code to select Laminate/Color. See this Section, pages 5 & 6 for Laminate/Color Codes.



SSCI laminated products are available in SSCI standard laminates, SSCI optional laminates, or Customer selected laminates.

For Product Information Call TOLL-FREE 1-800-323-7366 • (847) 537-9320 • Fax (847) 537-9061

Hours: 8:30am - 5:00pm CST Monday - Friday

Visit our website at: www.suburbansurgical.com

Finishing Components For Imperial Undercounter Reception Height Cabinets

Installation against 1 wall

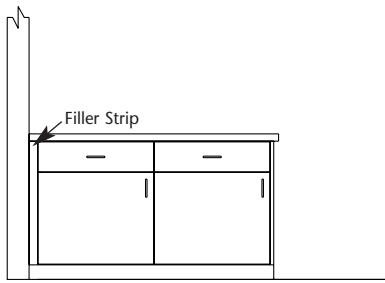

Installation between 2 walls

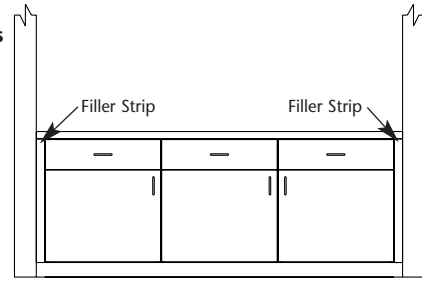

Filler Strips for Undercounter Reception Height Cabinets

P/N	WIDE		HEIGHT		DEPTH	
	In.	Cm	In.	Cm	In.	Cm
Full Height						
DRODAEAAAAGEJAC-___†	1.75	4.45	28.50	72.39	.625	1.59
DRODAEAAAANEJAC-___†	3.50	8.89	28.50	72.39	.625	1.59

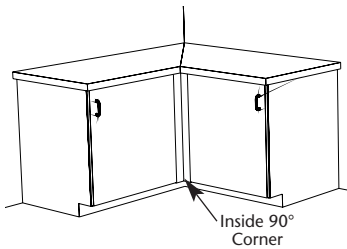

Inside 90° Corner for Undercounter Reception Height Cabinets

P/N	WIDE		HEIGHT		DEPTH	
	In.	Cm	In.	Cm	In.	Cm
DROAAEAAAIEJAI-___†	2.25	5.715	28.50	72.39	2.25	5.715

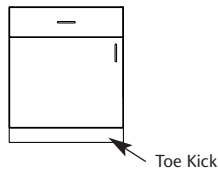

Toe Kick Lengths for Undercounter Reception Height Cabinets

P/N	WIDE		HEIGHT		DEPTH	
	In.	Cm	In.	Cm	In.	Cm
DROJAEAAAOTALAC-___†	96	243.84	3	7.62	.625	1.59

Important: These customer order requirements, in addition to other customer order requirements, must be satisfied prior to the beginning of manufacturing lead time:

*Specify 2-digit Code to select Cabinet Width. See this Section, page 4 for Cabinet Width Codes.

†Specify 4-digit Code to select Laminate/Color. See this Section, pages 5 & 6 for Laminate/Color Codes.



SSCI laminated products are available in SSCI standard laminates, SSCI optional laminates, or Customer selected laminates.

Finishing Components For Imperial Undercounter Reception Height Cabinets

End Panels for Reception Height Cabinets

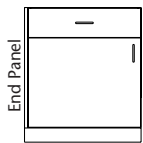

End Panel; Floor to Reception Height

P/N	THICKNESS		HEIGHT		DEPTH	
	In.	Cm	In.	Cm	In.	Cm
DROKAEAAAACEJCR-___†	.625	1.59	28.50	72.39	17.375	44.13
DROKAEAAAACEJCT-___†	.625	1.59	28.50	72.39	18	45.72
DROKAEAAAACEJDP-___†	.625	1.59	28.50	72.39	23.375	59.37
DROKAEAAAACEJDR-___†	.625	1.59	28.50	72.39	24	60.96

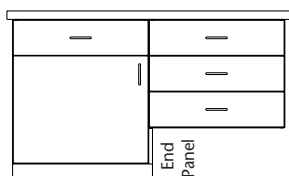

End Panel; Below Wall-Mount at Reception Height to Floor

P/N	THICKNESS		HEIGHT		DEPTH	
	In.	Cm	In.	Cm	In.	Cm
DROLAEAAAACBLCR-___†	.625	1.59	9.375	23.81	17.375	44.13
DROLAEAAAACBLCT-___†	.625	1.59	9.375	23.81	18	45.72
DROLAEAAAACBLDP-___†	.625	1.59	9.375	23.81	23.375	59.37
DROLAEAAAACBLDR-___†	.625	1.59	9.375	23.81	24	60.96

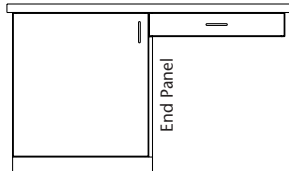

End Panel; Below Desk at Reception Height to Floor

P/N	THICKNESS		HEIGHT		DEPTH	
	In.	Cm	In.	Cm	In.	Cm
DROLAEAAAACDOCR-___†	.625	1.59	23.25	59.06	17.375	44.13
DROLAEAAAACDOCT-___†	.625	1.59	23.25	59.06	18	45.72
DROLAEAAAACDODP-___†	.625	1.59	23.25	59.06	23.375	59.37
DROLAEAAAACDODR-___†	.625	1.59	23.25	59.06	24	60.96



Back Panels for Reception Height Cabinets

Back Panel Custom Widths; Reception Height 28.50-in. (72.39cm) H

P/N	WIDTH		HEIGHT		THICKNESS	
	In.	Cm	In.	Cm	In.	Cm
DRONAEAAA ** EJA-___†	As Required		28.50	72.39	.625	1.59

Important: These customer order requirements, in addition to other customer order requirements, must be satisfied prior to the beginning of manufacturing lead time:

*Specify 2-digit Code to select Cabinet Width. See this Section, page 4 for Cabinet Width Codes.

†Specify 4-digit Code to select Laminate/Color. See this Section, pages 5 & 6 for Laminate/Color Codes.



SSCI laminated products are available in SSCI standard laminates, SSCI optional laminates, or Customer selected laminates.

For Product Information Call TOLL-FREE 1-800-323-7366 • (847) 537-9320 • Fax (847) 537-9061

Hours: 8:30am - 5:00pm CST Monday - Friday

Visit our website at: www.suburbansurgical.com

Imperial Undercounter Standard Height Cabinets



S
e
c
t
i
o
n

19

Imperial Undercounter Standard Height Cabinets



Open

1 adjustable shelf

Width: 12-in. to 42-in. (30.48cm to 106.68cm) in 3-in. (7.62cm) increments

Height: 34.50-in. (87.63cm)

Depth: 17.375-in. or 23.375-in. (44.13cm or 59.37cm)

P/N	DEPTH	
	In.	Cm
ARAAAAAA ** FHCR - _ _ _ †	17.375	44.13
ARAAAAAA ** FHDP - _ _ _ †	23.375	59.37

Open Corner

1 adjustable shelf

Width: 12-in. (30.48cm)

Height: 34.50-in. (87.63cm)

Depth: 17.375-in. or 23.375-in. (44.13cm or 59.37cm)



P/N	DEPTH	
	In.	Cm
AUAAAAAABVFHCR - _ _ _ †	17.375	44.13
AUAAAAAABVFHDP - _ _ _ †	23.375	59.37

1 Door Hinged left or right

1 adjustable shelf

Width: 12-in. to 24-in. (30.48cm to 60.96cm) in 3-in. (7.62cm) increments

Height: 34.50-in. (87.63cm)

Depth: 18-in. or 24-in. (45.72cm or 60.96cm)



P/N	DEPTH	
	In.	Cm
ARANAEAA ◊ ** FHCT - _ _ _ †	18	45.72
ARANAEAA ◊ ** FHDR - _ _ _ †	24	60.96

Pair of Hinged Doors

1 adjustable shelf

Width: 21-in. to 42-in. (53.34cm to 106.68cm) in 3-in. (7.62cm) increments

Height: 34.50-in. (87.63cm)

Depth: 18-in. or 24-in. (45.72cm or 60.96cm)

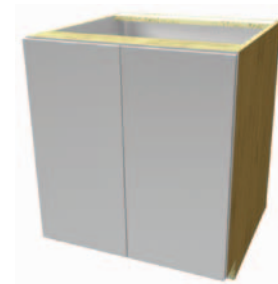

P/N	DEPTH	
	In.	Cm
ARAPAEAA ◊ ** FHCT - _ _ _ †	18	45.72
ARAPAEAA ◊ ** FHDR - _ _ _ †	24	60.96

Important: These customer order requirements, in addition to other customer order requirements, must be satisfied prior to the beginning of manufacturing lead time:

◊ Specify 1-digit Code to select type of drawer/door pull(s). See this Section, page 4 for drawer/door Pull Codes.

* Specify 2-digit Code to select Cabinet Width. See this Section, page 4 for Cabinet Width Codes.

† Specify 4-digit Code to select Laminate/Color. See this Section, pages 5 & 6 for Laminate/Color Codes.



SSCI laminated products are available in SSCI standard laminates, SSCI optional laminates, or Customer selected laminates.

For Product Information Call TOLL-FREE 1-800-323-7366 • (847) 537-9320 • Fax (847) 537-9061

Hours: 8:30am - 5:00pm CST Monday - Friday

Visit our website at: www.suburbansurgical.com

Imperial Undercounter Standard Height Cabinets

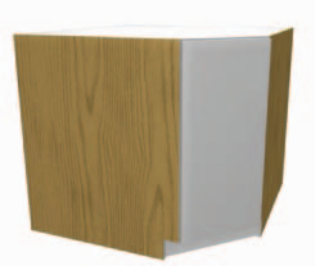

1 Door Hinged left or right, Corner

1 adjustable shelf

Width: 12-in. (30.48cm)

Height: 34.50-in.(87.63cm)

Depth: 18-in. or 24-in. (45.72cm or 60.96cm)

P/N	Hinged Left	Hinged Right	DEPTH		
			In.	Cm	
AUANAEAA	◇ BVFHCT - _ _ _ †	AUAOAEAA	◇ BVFHCT - _ _ _ †	18	45.72
AUANAEAA	◇ BVFHDR - _ _ _ †	AUAOAEAA	◇ BVFHDR - _ _ _ †	24	60.96

"C" Drawer or Sink Front, 1 Door Hinged left or right

Width: 12-in. to 24-in. (30.48cm to 60.96cm) in 3-in. (7.62cm) increments

Height: 34.50-in.(87.63cm)

Depth: 18-in. or 24-in. (45.72cm or 60.96cm)

P/N	Hinged Left	Hinged Right	DEPTH		
			In.	Cm	
"C" Drawer; 1 adjustable shelf					
ARDNAEAA	◇ ** FHCT - _ _ _ †	ARDOAEAA	◇ ** FHCT - _ _ _ †	18	45.72
ARDNAEAA	◇ ** FHDR - _ _ _ †	ARDOAEAA	◇ ** FHDR - _ _ _ †	24	60.96
"C" Sink Front					
ARFNAEAA	◇ ** FHCT - _ _ _ †	ARFOAEAA	◇ ** FHCT - _ _ _ †	18	45.72
ARFNAEAA	◇ ** FHDR - _ _ _ †	ARFOAEAA	◇ ** FHDR - _ _ _ †	24	60.96



"C" Drawer or Sink Front, Pair of Hinged Doors

Width: 21-in. to 36-in. (53.34cm to 91.44cm) in 3-in. (7.62cm) increments

Height: 34.50-in.(87.63cm)

Depth: 18-in. or 24-in. (45.72cm or 60.96cm)

P/N	Hinged Left	Hinged Right	DEPTH		
			In.	Cm	
"C" Drawer; 1 adjustable shelf					
ARDRAEAA	◇ ** FHCT - _ _ _ †			18	45.72
ARDRAEAA	◇ ** FHDR - _ _ _ †			24	60.96
"C" Sink Front					
ARFRAEAA	◇ ** FHCT - _ _ _ †			18	45.72
ARFRAEAA	◇ ** FHDR - _ _ _ †			24	60.96



"D" Drawer or Sink Front, 1 Door Hinged left or right

Width: 12-in. to 24-in. (30.48cm to 60.96cm) in 3-in. (7.62cm) increments

Height: 34.50-in.(87.63cm)

Depth: 18-in. or 24-in. (45.72cm or 60.96cm)

P/N	Hinged Left	Hinged Right	DEPTH		
			In.	Cm	
"D" Drawer; 1 adjustable shelf					
ARDPAEAA	◇ ** FHCT - _ _ _ †	ARDQAEAA	◇ ** FHCT - _ _ _ †	18	45.72
ARDPAEAA	◇ ** FHDR - _ _ _ †	ARDQAEAA	◇ ** FHDR - _ _ _ †	24	60.96
"D" Sink Front					
ARFPAEAA	◇ ** FHCT - _ _ _ †	ARFQAEAA	◇ ** FHCT - _ _ _ †	18	45.72
ARFPAEAA	◇ ** FHDR - _ _ _ †	ARFQAEAA	◇ ** FHDR - _ _ _ †	24	60.96



Important: These customer order requirements, in addition to other customer order requirements, must be satisfied prior to the beginning of manufacturing lead time:

◇ Specify 1-digit Code to select type of drawer/door pull(s). See this Section, page 4 for drawer/door Pull Codes.

* Specify 2-digit Code to select Cabinet Width. See this Section, page 4 for Cabinet Width Codes.

† Specify 4-digit Code to select Laminate/Color. See this Section, pages 5 & 6 for Laminate/Color Codes.



SSCI laminated products are available in SSCI standard laminates, SSCI optional laminates, or Customer selected laminates.

Imperial Undercounter Standard Height Cabinets

"D" Drawer or Sink Front, Pair of Hinged Doors



Width: 21-in. to 36-in. (53.34cm to 91.44cm) in 3-in. (7.62cm) increments

Height: 34.50-in.(87.63cm)

Depth: 18-in. or 24-in. (45.72cm or 60.96cm)

P/N	DEPTH	
	In.	Cm
"D" Drawer; 1 adjustable shelf		
ARDSAEAA ◊ ** FHCT - _ _ _ †	18	45.72
ARDSAEAA ◊ ** FHDR - _ _ _ †	24	60.96
"D" Sink Front		
ARFSAEAA ◊ ** FHCT - _ _ _ †	18	45.72
ARFSAEAA ◊ ** FHDR - _ _ _ †	24	60.96

3 "F" Drawers

Width: 12-in. to 36-in. (30.48cm to 91.44cm) in 3-in. (7.62cm) increments

Height: 34.50-in.(87.63cm)

Depth: 18-in. or 24-in. (45.72cm or 60.96cm)



P/N	DEPTH	
	In.	Cm
ARCBAAEA ◊ ** FHCT - _ _ _ †	18	45.72
ARCBAAEA ◊ ** FHDR - _ _ _ †	24	60.96

2 "E" Drawers, 1 "I" File Drawer

Width: 15-in. or 18-in. (38.10cm or 45.72cm)

Height: 34.50-in.(87.63cm)

Depth: 18-in. or 24-in. (45.72cm or 60.96cm)



P/N	DEPTH	
	In.	Cm
ARCEAEAA ◊ ** FHCT - _ _ _ †	18	45.72
ARCEAEAA ◊ ** FHDR - _ _ _ †	24	60.96

1 "B" Drawer, 2 "C" Drawers, 1 "I" File Drawer

Width: 15-in. or 18-in. (38.10cm or 45.72cm)

Height: 34.50-in.(87.63cm)

Depth: 18-in. or 24-in. (45.72cm or 60.96cm)



P/N	DEPTH	
	In.	Cm
ARCUEAA ◊ ** FHCT - _ _ _ †	18	45.72
ARCUEAA ◊ ** FHDR - _ _ _ †	24	60.96

Important: These customer order requirements, in addition to other customer order requirements, must be satisfied prior to the beginning of manufacturing lead time:

◊ Specify 1-digit Code to select type of drawer/door pull(s). See this Section, page 4 for drawer/door Pull Codes.

* Specify 2-digit Code to select Cabinet Width. See this Section, page 4 for Cabinet Width Codes.

† Specify 4-digit Code to select Laminate/Color. See this Section, pages 5 & 6 for Laminate/Color Codes.



SSCI laminated products are available in SSCI standard laminates, SSCI optional laminates, or Customer selected laminates.

For Product Information Call TOLL-FREE 1-800-323-7366 • (847) 537-9320 • Fax (847) 537-9061

Hours: 8:30am - 5:00pm CST Monday - Friday

Visit our website at: www.suburbansurgical.com

Imperial Undercounter Standard Height Cabinets



1 "B", 1 "D", 2 "E" Drawers

Width: 12-in. to 36-in. (30.48cm to 91.44cm) in 3-in. (7.62cm) increments

Height: 34.50-in.(87.63cm)

Depth: 18-in. or 24-in. (45.72cm or 60.96cm)

P/N	DEPTH	
	In.	Cm
ARCQAEAA ◊ ** FHCT - _ _ _ _ †	18	45.72
ARCQAEAA ◊ ** FHDR - _ _ _ _ †	24	60.96

1 "K" Keyboard Drawer, 3 "E" Drawers

Width: 18-in. to 24-in. (45.72cm to 60.96cm) in 3-in. (7.62cm) increments

Height: 34.50-in.(87.63cm)

Depth: 18-in. or 24-in. (45.72cm or 60.96cm)



P/N	DEPTH	
	In.	Cm
ARCWAEAA ◊ ** FHCT - _ _ _ _ †	18	45.72
ARCWAEAA ◊ ** FHDR - _ _ _ _ †	24	60.96

4 "D" Drawers

Width: 12-in. to 36-in. (30.48cm to 91.44cm) in 3-in. (7.62cm) increments

Height: 34.50-in.(87.63cm)

Depth: 18-in. or 24-in. (45.72cm or 60.96cm)



P/N	DEPTH	
	In.	Cm
ARCOAEAA ◊ ** FHCT - _ _ _ _ †	18	45.72
ARCOAEAA ◊ ** FHDR - _ _ _ _ †	24	60.96

2 "C", 2 "E" Drawers

Width: 12-in. to 36-in. (30.48cm to 91.44cm) in 3-in. (7.62cm) increments

Height: 34.50-in.(87.63cm)

Depth: 18-in. or 24-in. (45.72cm or 60.96cm)



P/N	DEPTH	
	In.	Cm
ARCSAEAA ◊ ** FHCT - _ _ _ _ †	18	45.72
ARCSAEAA ◊ ** FHDR - _ _ _ _ †	24	60.96

Important: These customer order requirements, in addition to other customer order requirements, must be satisfied prior to the beginning of manufacturing lead time:

◊ Specify 1-digit Code to select type of drawer/door pull(s). See this Section, page 4 for drawer/door Pull Codes.

* Specify 2-digit Code to select Cabinet Width. See this Section, page 4 for Cabinet Width Codes.

† Specify 4-digit Code to select Laminate/Color. See this Section, pages 5 & 6 for Laminate/Color Codes.



SSCI laminated products are available in SSCI standard laminates, SSCI optional laminates, or Customer selected laminates.

Finishing Components For Imperial Undercounter Standard Height Cabinets

Installation against 1 wall

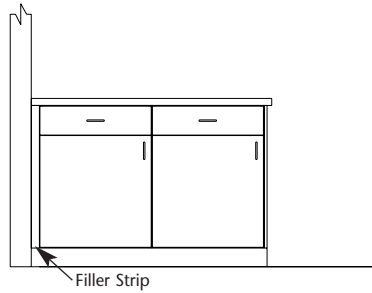

Installation between 2 walls

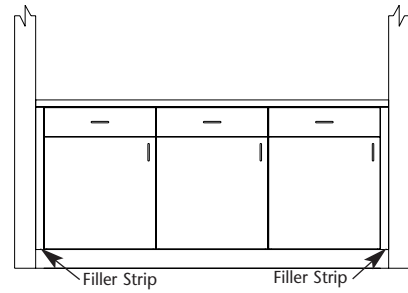

Filler Strips for Undercounter Standard Height Cabinets

P/N	WIDE		HEIGHT		DEPTH	
	In.	Cm	In.	Cm	In.	Cm
Full Height						
DRODAEAAAAGFHAC-____†	1.75	4.45	34.50	87.63	.625	1.59
DRODAEAAAANFHAC-____†	3.50	8.89	34.50	87.63	.625	1.59

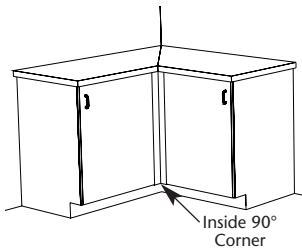

Inside 90° Corner for Undercounter Standard Height Cabinets

P/N	WIDE		HEIGHT		DEPTH	
	In.	Cm	In.	Cm	In.	Cm
DROAAEAAAIFHAI-____†	2.25	5.715	34.50	87.63	2.25	5.715

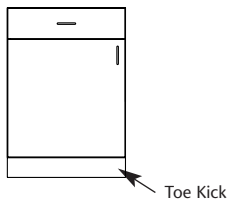

Toe Kick Lengths for Undercounter Standard Height Cabinets

P/N	WIDE		HEIGHT		DEPTH	
	In.	Cm	In.	Cm	In.	Cm
DROJAEAAAOTAPAC-____†	96	243.84	4	10.16	.625	1.59

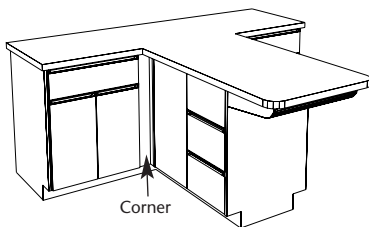

Corner for T-Mounting Treatment/Prep-Procedure Tables

P/N	WIDE		HEIGHT		DEPTH	
	In.	Cm	In.	Cm	In.	Cm
Left						
DROHAEAAAAMFHAD-____†	3.25	8.25	34.50	87.63	1	2.54
Right						
DROIAEAAAAMFHAD-____†	3.25	8.25	34.50	87.63	1	2.54

Important: These customer order requirements, in addition to other customer order requirements, must be satisfied prior to the beginning of manufacturing lead time:

*Specify 2-digit Code to select Cabinet Width. See this Section, page 4 for Cabinet Width Codes.

†Specify 4-digit Code to select Laminate/Color. See this Section, pages 5 & 6 for Laminate/Color Codes.



SSCI laminated products are available in SSCI standard laminates, SSCI optional laminates, or Customer selected laminates.

For Product Information Call TOLL-FREE 1-800-323-7366 • (847) 537-9320 • Fax (847) 537-9061

Hours: 8:30am - 5:00pm CST Monday - Friday

Visit our website at: www.suburbansurgical.com

Finishing Components For Imperial Undercounter Standard Height Cabinets

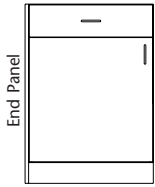

End Panels for Undercounter Standard Height Cabinets

End Panel; Floor to Standard Height

P/N	THICKNESS		HEIGHT		DEPTH	
	In.	Cm	In.	Cm	In.	Cm
DROKAEAAAACFHCR-___†	.625	1.59	34.50	87.63	17.375	44.13
DROKAEAAAACFHCT-___†	.625	1.59	34.50	87.63	18	45.72
DROKAEAAAACFHDP-___†	.625	1.59	34.50	87.63	23.375	59.37
DROKAEAAAACFHDR-___†	.625	1.59	34.50	87.63	24	60.96

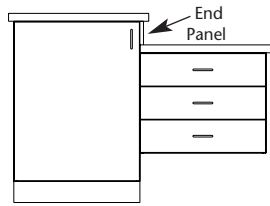

End Panel; Above Reception Height to Standard Height

P/N	THICKNESS		HEIGHT		DEPTH	
	In.	Cm	In.	Cm	In.	Cm
DROLAEAAAACARCR-___†	.625	1.59	4.50	11.43	17.375	44.13
DROLAEAAAACARCT-___†	.625	1.59	4.50	11.43	18	45.72
DROLAEAAAACARDP-___†	.625	1.59	4.50	11.43	23.375	59.37
DROLAEAAAACARDR-___†	.625	1.59	4.50	11.43	24	60.96

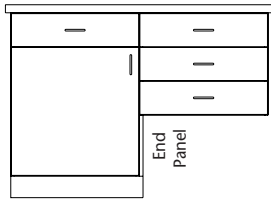

End Panel; Below Wall-Mount at Standard Height to Floor

P/N	THICKNESS		HEIGHT		DEPTH	
	In.	Cm	In.	Cm	In.	Cm
DROLAEAAAACJCR-___†	.625	1.59	15.375	39.05	17.375	44.13
DROLAEAAAACJCT-___†	.625	1.59	15.375	39.05	18	45.72
DROLAEAAAACJDP-___†	.625	1.59	15.375	39.05	23.375	59.37
DROLAEAAAACJDR-___†	.625	1.59	15.375	39.05	24	60.96

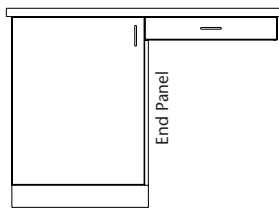

End Panel; Below Desk at Standard Height to Floor

P/N	THICKNESS		HEIGHT		DEPTH	
	In.	Cm	In.	Cm	In.	Cm
DROLAEAAAACEMCR-___†	.625	1.59	29.25	74.30	17.375	44.13
DROLAEAAAACEMCT-___†	.625	1.59	29.25	74.30	18	45.72
DROLAEAAAACEMDP-___†	.625	1.59	29.25	74.30	23.375	59.37
DROLAEAAAACEMDR-___†	.625	1.59	29.25	74.30	24	60.96

Back Panels for Undercounter Standard Height Cabinets

Back Panel Custom Widths; Standard Height 34.50-in. (87.63cm) H

P/N	WIDTH		HEIGHT		THICKNESS	
	In.	Cm	In.	Cm	In.	Cm
DRONAEAAA ** FHAA-___†	As Required		34.50	87.63	.625	1.59

Important: These customer order requirements, in addition to other customer order requirements, must be satisfied prior to the beginning of manufacturing lead time:

*Specify 2-digit Code to select Cabinet Width. See this Section, page 4 for Cabinet Width Codes.

†Specify 4-digit Code to select Laminate/Color. See this Section, pages 5 & 6 for Laminate/Color Codes.



SSCI laminated products are available in SSCI standard laminates, SSCI optional laminates, or Customer selected laminates.

Imperial Undercounter Exam Height Cabinets



Exam Height Cabinets used to create Greeter Stations in Reception Area



Imperial Undercounter Exam Height Cabinets



Open

1 adjustable shelf

Width: 12-in. to 42-in. (30.48cm to 106.68cm) in 3-in. (7.62cm) increments

Height: 40.75-in. (103.51cm)

Depth: 17.375-in. or 23.375-in. (44.13cm or 59.37cm)

P/N	DEPTH	
	In.	Cm
ARAAAAAA ** GGCR - ___ †	17.375	44.13
ARAAAAAA ** GGDP - ___ †	23.375	59.37

Open Corner

1 adjustable shelf

Width: 12-in. (30.48cm)

Height: 40.75-in. (103.51cm)

Depth: 17.375-in. or 23.375-in. (44.13cm or 59.37cm)

P/N	DEPTH	
	In.	Cm
AUAAAAAABVGGCR - ___ †	17.375	44.13
AUAAAAAABVGGDP - ___ †	23.375	59.37



1 Door Hinged left or right

1 adjustable shelf

Width: 12-in. to 24-in. (30.48cm to 60.96cm) in 3-in. (7.62cm) increments

Height: 40.75-in. (103.51cm)

Depth: 18-in. or 24-in. (45.72cm or 60.96cm)

P/N	DEPTH	
	In.	Cm
ARANAEEA ◊ ** GGCT - ___ †	18	45.72
ARANAEEA ◊ ** GGDR - ___ †	24	60.96



Pair of Hinged Doors

1 adjustable shelf

Width: 21-in. to 42-in. (53.34cm to 106.68cm) in 3-in. (7.62cm) increments

Height: 40.75-in. (103.51cm)

Depth: 18-in. or 24-in. (45.72cm or 60.96cm)

P/N	DEPTH	
	In.	Cm
ARAPAEAA ◊ ** GGCT - ___ †	18	45.72
ARAPAEAA ◊ ** GGDR - ___ †	24	60.96

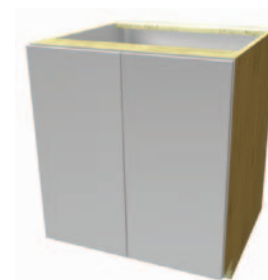

Important: These customer order requirements, in addition to other customer order requirements, must be satisfied prior to the beginning of manufacturing lead time:

◊ Specify 1-digit Code to select type of drawer/door pull(s). See this Section, page 4 for drawer/door Pull Codes.

* Specify 2-digit Code to select Cabinet Width. See this Section, page 4 for Cabinet Width Codes.

† Specify 4-digit Code to select Laminate/Color. See this Section, pages 5 & 6 for Laminate/Color Codes.



SSCI laminated products are available in SSCI standard laminates, SSCI optional laminates, or Customer selected laminates.

Imperial Undercounter Exam Height Cabinets



1 Door Hinged left or right, Corner

1 adjustable shelf

Width: 12-in. (30.48cm)

Height: 40.75-in. (103.51cm)

Depth: 18-in. or 24-in. (45.72cm or 60.96cm)

P/N Hinged Left	Hinged Right	DEPTH	
		In.	Cm
AUANAEAA ◊ BVGGCT - ___ †	AUAOAEAA ◊ BVGGCT - ___ †	18	45.72
AUANAEAA ◊ BVGGDR - ___ †	AUAOAEAA ◊ BVGGDR - ___ †	24	60.96

"C" Drawer or Sink Front, 1 Door Hinged left or right

Width: 12-in. to 24-in. (30.48cm to 60.96cm) in 3-in. (7.62cm) increments

Height: 40.75-in. (103.51cm)

Depth: 18-in. or 24-in. (45.72cm or 60.96cm)

P/N Hinged Left	Hinged Right	DEPTH	
		In.	Cm
"C" Drawer; 1 adjustable shelf			
ARDNAEAA ◊ ** GGCT - ___ †	ARDOAEAA ◊ ** GGCT - ___ †	18	45.72
ARDNAEAA ◊ ** GGDR - ___ †	ARDOAEAA ◊ ** GGDR - ___ †	24	60.96
"C" Sink Front			
ARFNAEAA ◊ ** GGCT - ___ †	ARFOAEAA ◊ ** GGCT - ___ †	18	45.72
ARFNAEAA ◊ ** GGDR - ___ †	ARFOAEAA ◊ ** GGDR - ___ †	24	60.96



"C" Drawer or Sink Front, Pair of Hinged Doors

Width: 21-in. to 36-in. (53.34cm to 91.44cm) in 3-in. (7.62cm) increments

Height: 40.75-in. (103.51cm)

Depth: 18-in. or 24-in. (45.72cm or 60.96cm)

P/N	DEPTH	
	In.	Cm
"C" Drawer; 1 adjustable shelf		
ARDRAEAA ◊ ** GGCT - ___ †	18	45.72
ARDRAEAA ◊ ** GGDR - ___ †	24	60.96
"C" Sink Front		
ARFRAEAA ◊ ** GGCT - ___ †	18	45.72
ARFRAEAA ◊ ** GGDR - ___ †	24	60.96



"D" Drawer or Sink Front, 1 Door Hinged left or right

Width: 12-in. to 24-in. (30.48cm to 60.96cm) in 3-in. (7.62cm) increments

Height: 40.75-in. (103.51cm)

Depth: 18-in. or 24-in. (45.72cm or 60.96cm)

P/N Hinged Left	Hinged Right	DEPTH	
		In.	Cm
"D" Drawer; 1 adjustable shelf			
ARDPAEAA ◊ ** GGCT - ___ †	ARDQAEAA ◊ ** GGCT - ___ †	18	45.72
ARDPAEAA ◊ ** GGDR - ___ †	ARDQAEAA ◊ ** GGDR - ___ †	24	60.96
"D" Sink Front			
ARFPAEAA ◊ ** GGCT - ___ †	ARFQAEAA ◊ ** GGCT - ___ †	18	45.72
ARFPAEAA ◊ ** GGDR - ___ †	ARFQAEAA ◊ ** GGDR - ___ †	24	60.96



Important: These customer order requirements, in addition to other customer order requirements, must be satisfied prior to the beginning of manufacturing lead time:

◊ Specify 1-digit Code to select type of drawer/door pull(s). See this Section, page 4 for drawer/door Pull Codes.

* Specify 2-digit Code to select Cabinet Width. See this Section, page 4 for Cabinet Width Codes.

† Specify 4-digit Code to select Laminate/Color. See this Section, pages 5 & 6 for Laminate/Color Codes.



SSCI laminated products are available in SSCI standard laminates, SSCI optional laminates, or Customer selected laminates.

For Product Information Call TOLL-FREE 1-800-323-7366 • (847) 537-9320 • Fax (847) 537-9061

Hours: 8:30am - 5:00pm CST Monday - Friday

Visit our website at: www.suburbansurgical.com

Imperial Undercounter Exam Height Cabinets

"D" Drawer or Sink Front, Pair of Hinged Doors



Width: 21-in. to 36-in. (53.34cm to 91.44cm) in 3-in. (7.62cm) increments
Height: 40.75-in. (103.51cm)
Depth: 18-in. or 24-in. (45.72cm or 60.96cm)

P/N	DEPTH	
	In.	Cm
"D" Drawer; 1 adjustable shelf		
ARDSAEAA ◊ ** GGCT - _ _ _ _ †	18	45.72
ARDSAEAA ◊ ** GGDR - _ _ _ _ †	24	60.96
"D" Sink Front		
ARFSAEAA ◊ ** GGCT - _ _ _ _ †	18	45.72
ARFSAEAA ◊ ** GGDR - _ _ _ _ †	24	60.96

1 "B", 1 "C", 2 "H" Drawers

Width: 12-in. to 36-in. (30.48cm to 91.44cm) in 3-in. (7.62cm) increments
Height: 40.75-in. (103.51cm)
Depth: 18-in. or 24-in. (45.72cm or 60.96cm)

P/N	DEPTH	
	In.	Cm
ARCPAEAA ◊ ** GGCT - _ _ _ _ †	18	45.72
ARCPAEAA ◊ ** GGDR - _ _ _ _ †	24	60.96



2 "D", 1 "F", 1 "G" Drawers

Width: 12-in. to 36-in. (30.48cm to 91.44cm) in 3-in. (7.62cm) increments
Height: 40.75-in. (103.51cm)
Depth: 18-in. or 24-in. (45.72cm or 60.96cm)

P/N	DEPTH	
	In.	Cm
ARCTAEAA ◊ ** GGCT - _ _ _ _ †	18	45.72
ARCTAEAA ◊ ** GGDR - _ _ _ _ †	24	60.96



2 "C" Drawers, 1 "G" Drawer, 1 "I" File Drawer

Width: 15-in. or 18-in. (38.10cm or 45.72cm)
Height: 40.75-in. (103.51cm)
Depth: 18-in. or 24-in. (45.72cm or 60.96cm)

P/N	DEPTH	
	In.	Cm
ARCVAEAA ◊ ** GGCT - _ _ _ _ †	18	45.72
ARCVAEAA ◊ ** GGDR - _ _ _ _ †	24	60.96



Important: These customer order requirements, in addition to other customer order requirements, must be satisfied prior to the beginning of manufacturing lead time:

◊ Specify 1-digit Code to select type of drawer/door pull(s). See this Section, page 4 for drawer/door Pull Codes.

* Specify 2-digit Code to select Cabinet Width. See this Section, page 4 for Cabinet Width Codes.

† Specify 4-digit Code to select Laminate/Color. See this Section, pages 5 & 6 for Laminate/Color Codes.



SSCI laminated products are available in SSCI standard laminates, SSCI optional laminates, or Customer selected laminates.

Finishing Components For Imperial Exam Height Cabinets

Installation against 1 wall

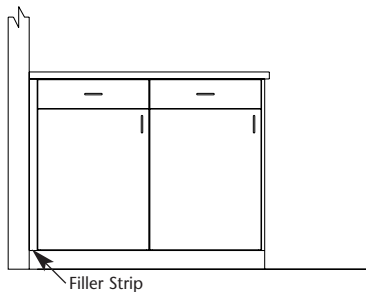

Installation between 2 walls

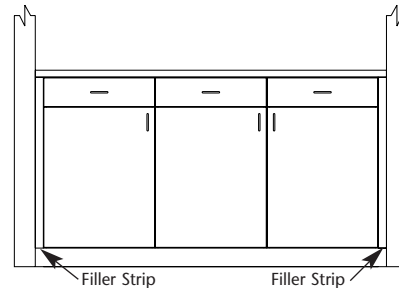

Filler Strips for Undercounter Exam Height Cabinets

P/N	WIDE		HEIGHT		DEPTH	
	In.	Cm	In.	Cm	In.	Cm
DRODAEAAAAGGAC-___†	1.75	4.45	40.75	103.51	.625	.159
DRODAEAAAANGGAC-___†	3.50	8.89	40.75	103.51	.625	.159

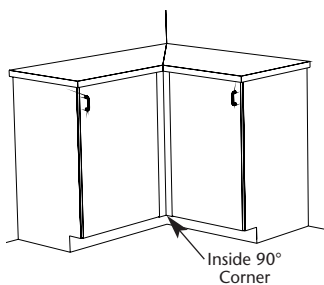

Inside 90° Corner for Undercounter Exam Height Cabinets

P/N	WIDE		HEIGHT		DEPTH	
	In.	Cm	In.	Cm	In.	Cm
DROAAEAAAIGGAI-___†	2.25	5.715	40.75	103.51	2.25	5.715

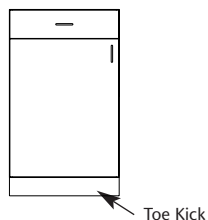

Toe Kick Lengths for Undercounter Exam Height Cabinets

P/N	WIDE		HEIGHT		DEPTH	
	In.	Cm	In.	Cm	In.	Cm
DROJAEAAAOTAPAC-___†	96	243.84	4	10.16	.625	1.59

Important: These customer order requirements, in addition to other customer order requirements, must be satisfied prior to the beginning of manufacturing lead time:

*Specify 2-digit Code to select Cabinet Width. See this Section, page 4 for Cabinet Width Codes.

†Specify 4-digit Code to select Laminate/Color. See this Section, pages 5 & 6 for Laminate/Color Codes.



SSCI laminated products are available in SSCI standard laminates, SSCI optional laminates, or Customer selected laminates.

For Product Information Call TOLL-FREE 1-800-323-7366 • (847) 537-9320 • Fax (847) 537-9061

Hours: 8:30am - 5:00pm CST Monday - Friday

Visit our website at: www.suburbansurgical.com

Finishing Components For Imperial Undercounter Exam Height Cabinets

End Panels for Undercounter Exam Height Cabinets

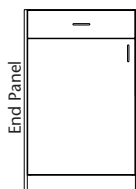

End Panel; Floor to Exam Height

P/N	THICKNESS		HEIGHT		DEPTH	
	In.	Cm	In.	Cm	In.	Cm
DROKAEAAAACGGCR-___†	.625	1.59	40.75	103.51	17.375	44.13
DROKAEAAAACGGCT-___†	.625	1.59	40.75	103.51	18	45.72
DROKAEAAAACGGDP-___†	.625	1.59	40.75	103.51	23.375	59.37
DROKAEAAAACGGDR-___†	.625	1.59	40.75	103.51	24	60.96

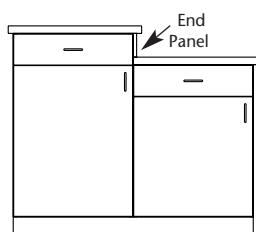

End Panel; Above Standard Height to Exam Height

P/N	THICKNESS		HEIGHT		DEPTH	
	In.	Cm	In.	Cm	In.	Cm
DWOLAEAAAACASCR-___†	.625	1.59	4.75	12.06	17.375	44.13
DWOLAEAAAACASCT-___†	.625	1.59	4.75	12.06	18	45.72
DWOLAEAAAACASDP-___†	.625	1.59	4.75	12.06	23.375	59.37
DWOLAEAAAACASDR-___†	.625	1.59	4.75	12.06	24	60.96

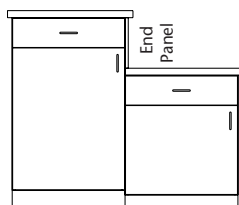

End Panel; Above Reception Height to Exam Height

P/N	THICKNESS		HEIGHT		DEPTH	
	In.	Cm	In.	Cm	In.	Cm
DWOLAEAAAACBQCR-___†	.625	1.59	10.75	27.30	17.375	44.13
DWOLAEAAAACBQCT-___†	.625	1.59	10.75	27.30	18	45.72
DWOLAEAAAACBQDP-___†	.625	1.59	10.75	27.30	23.375	59.37
DWOLAEAAAACBQDR-___†	.625	1.59	10.75	27.30	24	60.96

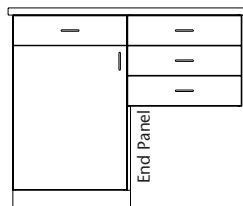

End Panel; Below Wallmounted at Exam Height to Floor

P/N	THICKNESS		HEIGHT		DEPTH	
	In.	Cm	In.	Cm	In.	Cm
DROLAEAAAACDICR-___†	.625	1.59	21.625	54.93	17.375	44.13
DROLAEAAAACDICT-___†	.625	1.59	21.625	54.93	18	45.72
DROLAEAAAACDIDP-___†	.625	1.59	21.625	54.93	23.375	59.37
DROLAEAAAACDIDR-___†	.625	1.59	21.625	54.93	24	60.96

Important: These customer order requirements, in addition to other customer order requirements, must be satisfied prior to the beginning of manufacturing lead time:

*Specify 2-digit Code to select Cabinet Width. See this Section, page 4 for Cabinet Width Codes.

†Specify 4-digit Code to select Laminate/Color. See this Section, pages 5 & 6 for Laminate/Color Codes.



SSCI laminated products are available in SSCI standard laminates, SSCI optional laminates, or Customer selected laminates.

Finishing Components For Imperial Undercounter Exam Height Cabinets

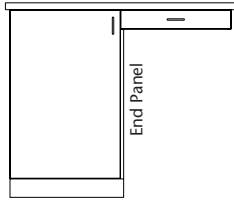

End Panel; Below Desk at Exam Height to Floor

P/N	THICKNESS		HEIGHT		DEPTH	
	In.	Cm	In.	Cm	In.	Cm
DROLAEAAAACFLCR-___†	.625	1.59	35.50	90.17	17.375	44.13
DROLAEAAAACFLCT-___†	.625	1.59	35.50	90.17	18	45.72
DROLAEAAAACFLDP-___†	.625	1.59	35.50	90.17	23.375	59.37
DROLAEAAAACFLDR-___†	.625	1.59	35.50	90.17	24	60.96



Back Panels for Exam Height Cabinets

Back Panel Custom Widths; Exam Height 40.75-in. (103.51cm) H

P/N	WIDTH		HEIGHT		THICKNESS	
	In.	Cm	In.	Cm	In.	Cm
DRONAEAAA ** GGAA-___†	As Required		40.75	103.51	.625	1.59

Important: These customer order requirements, in addition to other customer order requirements, must be satisfied prior to the beginning of manufacturing lead time:

*Specify 2-digit Code to select Cabinet Width. See this Section, page 4 for Cabinet Width Codes.

†Specify 4-digit Code to select Laminate/Color. See this Section, pages 5 & 6 for Laminate/Color Codes.



SSCI laminated products are available in SSCI standard laminates, SSCI optional laminates, or Customer selected laminates.

For Product Information Call TOLL-FREE 1-800-323-7366 • (847) 537-9320 • Fax (847) 537-9061

Hours: 8:30am - 5:00pm CST Monday - Friday

Visit our website at: www.suburbansurgical.com

Imperial 1 Cupboard Full Height Cabinets

Where space allows, Full Height Cabinets can solve practically any storage problems. Not only do we sell Full Height Cabinets with one vertical cupboard, our selection also includes Cabinets with two vertical cupboards in your choice of

three different configurations. All are offered with single hinged doors or a Pair of Hinged Doors. Or choose Open Cabinets with no doors. All include adjustable shelves to give you a wide variety of storage solutions.



Imperial 1 Cupboard Full Height Cabinets



Open

5 Adjustable Shelves

Width: 12-in. to 36-in. (30.48cm to 91.44cm) in 3-in. (7.62cm) increments

Height: 84-in. (213.36cm)

Cupboard: 78.75-in. (200.03cm)

P/N	DEPTH	
	In.	Cm
AWAAAAAA * MXCR - _ _ _ †	17.375	44.13
AWAAAAAA * MXDP - _ _ _ †	23.375	59.37

Open Corner

5 Adjustable Shelves

Width: 12-in. (30.48cm)

Height: 84-in. (213.36cm)

Cupboard: 78.75-in. (200.03cm)

P/N	DEPTH	
	In.	Cm
AZAAAAAABVMXCR - _ _ _ †	17.375	44.13
AZAAAAAABVMXDP - _ _ _ †	23.375	59.37



1 Door Hinged left or right

5 Adjustable Shelves

Width: 12-in. to 24-in. (30.48cm to 60.96cm) in 3-in. (7.62cm) increments

Height: 84-in. (213.36cm)

Cupboard: 78.75-in. (200.03cm); 1 Door Hinged left or right

P/N	DEPTH	
	In.	Cm
AWANAEAA ◊ ** MXCT - _ _ _ †	18	45.72
AWANAEAA ◊ ** MXDR - _ _ _ †	24	60.96

Pair of Hinged Doors

5 Adjustable Shelves

Width: 21-in. to 36-in. (53.34cm to 91.44cm) in 3-in. (7.62cm) increments

Height: 84-in. (213.36cm)

Cupboard: 78.75-in. (200.03cm); Pair of Hinged Doors

P/N	DEPTH	
	In.	Cm
AWAPAEAA ◊ ** MXCT - _ _ _ †	18	45.72
AWAPAEAA ◊ ** MXDR - _ _ _ †	24	60.96



1 Door Hinged left or right, Corner

5 Adjustable Shelves

Width: 12-in. (30.48cm)

Height: 84-in. (213.36cm)

Cupboard: 78.75-in. (200.03cm); 1 Door Hinged left or right

P/N	DEPTH	
	In.	Cm
AZANAEAA ◊ BVMXCT - _ _ _ †	18	45.72
AZANAEAA ◊ BVMXDR - _ _ _ †	24	60.96

Important: These customer order requirements, in addition to other customer order requirements, must be satisfied prior to the beginning of manufacturing lead time:

◊ Specify 1-digit Code to select type of drawer/door pull(s). See this Section, page 4 for drawer/door Pull Codes.

* Specify 2-digit Code to select Cabinet Width. See this Section, page 4 for Cabinet Width Codes.

† Specify 4-digit Code to select Laminate/Color. See this Section, pages 5 & 6 for Laminate/Color Codes.



SSCI laminated products are available in SSCI standard laminates, SSCI optional laminates, or Customer selected laminates.

For Product Information Call TOLL-FREE 1-800-323-7366 • (847) 537-9320 • Fax (847) 537-9061

Hours: 8:30am - 5:00pm CST Monday - Friday

Visit our website at: www.suburbansurgical.com

Imperial 2 Cupboard Full Height Cabinets 34.50-in. (87.63cm)H Fixed Shelf



2 Open Cupboards

1 Fixed Shelf at 34.50-in. (87.63cm) H
4 Adjustable Shelves

Width: 12-in. to 36-in. (30.48cm to 91.44cm) in 3-in. (7.62cm) increments

Height: 84-in. (213.36cm)

Upper Cupboard: 48.875-in. (124.14cm) H

Lower Cupboard: 29.250-in. (74.30cm) H

P/N	DEPTH	
	In.	Cm
BWIAAAAA * _ MXCR - _ _ _ _ †	17.375	44.13
BWIAAAAA * _ MXDP - _ _ _ _ †	23.375	59.37

2 Open Cupboards, Corner

1 Fixed Shelf at 34.50-in. (87.63cm) H
4 Adjustable Shelves

Width: 12-in. (30.48cm)

Height: 84-in. (213.36cm)

Upper Cupboard: 48.875-in. (124.14cm) H

Lower Cupboard: 29.250-in. (74.30cm) H

P/N	DEPTH	
	In.	Cm
BZIAAAAAABVMXCR - _ _ _ _ †	17.375	44.13
BZIAAAAAABVMXDP - _ _ _ _ †	23.375	59.37

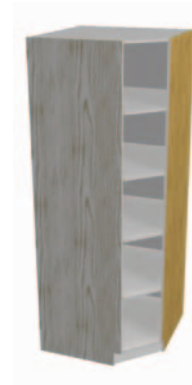

Open Cupboard over 1 Door Hinged left or right

1 Fixed Shelf at 34.50-in. (87.63cm) H
4 Adjustable Shelves

Width: 12-in. to 24-in. (30.48cm to 60.96cm) in 3-in. (7.62cm) increments

Height: 84-in. (213.36cm)

Upper Cupboard: 48.875-in. (124.14cm) H

Lower Cupboard: 29.250-in. (74.30cm) H; 1Door Hinged left or right

P/N	DEPTH	
	In.	Cm
BWIBAEAA ◊ ** MXCT - _ _ _ _ †	18	45.72
BWIBAEAA ◊ ** MXDR - _ _ _ _ †	24	60.96

Open Cupboard over Pair of Hinged Doors

1 Fixed Shelf at 34.50-in. (87.63cm) H
4 Adjustable Shelves

Width: 21-in. to 36-in. (53.34cm to 91.44cm) in 3-in. (7.62cm) increments

Height: 84-in. (213.36cm)

Upper Cupboard: 48.875-in. (124.14cm) H

Lower Cupboard: 29.250-in. (74.30cm) H; Pair of Hinged Doors

P/N	DEPTH	
	In.	Cm
BWIDAEAA ◊ ** MXCT - _ _ _ _ †	18	45.72
BWIDAEAA ◊ ** MXDR - _ _ _ _ †	24	60.96



Important: These customer order requirements, in addition to other customer order requirements, must be satisfied prior to the beginning of manufacturing lead time:

◊ Specify 1-digit Code to select type of drawer/door pull(s). See this Section, page 4 for drawer/door Pull Codes.

* Specify 2-digit Code to select Cabinet Width. See this Section, page 4 for Cabinet Width Codes.

† Specify 4-digit Code to select Laminate/Color. See this Section, pages 5 & 6 for Laminate/Color Codes.



SSCI laminated products are available in SSCI standard laminates, SSCI optional laminates, or Customer selected laminates.

Imperial 2 Cupboard Full Height Cabinets 34.50-in. (87.63cm)H Fixed Shelf

Open Cupboard over 1 Door Hinged left or right, Corner

1 Fixed Shelf at 34.50-in. (87.63cm) H

4 Adjustable Shelves

Width: 12-in. (30.48cm)

Height: 84-in. (213.36cm)

Upper Cupboard: 48.875-in. (124.14cm) H

Lower Cupboard: 29.250-in. (74.30cm) H; 1 Door Hinged Left or Right

P/N Hinged Left	Hinged Right	DEPTH	
		In.	Cm
BZIBAEAA ◊ BVMXCT - _ _ _ _ †	BZICAEAA ◊ BVMXCT - _ _ _ _ †	18	45.72
BZIBAEAA ◊ BVMXDR - _ _ _ _ †	BZICAEAA ◊ BVMXDR - _ _ _ _ †	24	60.96



1 Door over 1 Door, Hinged left or right

1 Fixed Shelf at 34.50-in. (87.63cm) H

4 Adjustable Shelves

Width: 12-in. to 24-in. (30.48cm to 60.96cm) in 3-in. (7.62cm) increments

Height: 84-in. (213.36cm)

Upper Cupboard: 48.875-in. (124.14cm) H; 1 Door Hinged left or right

Lower Cupboard: 29.250-in. (74.30cm) H; 1 Door Hinged left or right

P/N Hinged Left	Hinged Right	DEPTH	
		In.	Cm
BWIMAEAA ◊ ** MXCT - _ _ _ _ †	BWINAEAA ◊ ** MXCT - _ _ _ _ †	18	45.72
BWIMAEAA ◊ ** MXDR - _ _ _ _ †	BWINAEAA ◊ ** MXDR - _ _ _ _ †	24	60.96

Pair of Hinged Doors over Pair of Hinged Doors

1 Fixed Shelf at 34.50-in. (87.63cm) H

4 Adjustable Shelves

Width: 21-in. to 36-in. (53.34cm to 91.44cm) in 3-in. (7.62cm) increments

Height: 84-in. (213.36cm)

Upper Cupboard: 48.875-in. (124.14cm) H; Pair of Hinged Doors

Lower Cupboard: 29.250-in. (74.30cm) H; Pair of Hinged Doors

P/N	DEPTH	
	In.	Cm
BWIOAEAA ◊ ** MXCT - _ _ _ _ †	18	45.72
BWIOAEAA ◊ ** MXDR - _ _ _ _ †	24	60.96



1 Door over 1 Door, Hinged left or right, Corner

1 Fixed Shelf at 34.50-in. (87.63cm) H

4 Adjustable Shelves

Width: 12-in. (30.48cm)

Height: 84-in. (213.36cm)

Upper Cupboard: 48.875-in. (124.14cm) H; 1 Door Hinged left or right

Lower Cupboard: 29.250-in. (74.30cm) H; 1 Door Hinged left or right

P/N Hinged Left	Hinged Right	DEPTH	
		In.	Cm
BZIMAEAA ◊ BVMXCT - _ _ _ _ †	BZINAEAA ◊ BVMXCT - _ _ _ _ †	18	45.72
BZIMAEAA ◊ BVMXDR - _ _ _ _ †	BZINAEAA ◊ BVMXDR - _ _ _ _ †	24	60.96

Important: These customer order requirements, in addition to other customer order requirements, must be satisfied prior to the beginning of manufacturing lead time:

◊ Specify 1-digit Code to select type of drawer/door pull(s). See this Section, page 4 for drawer/door Pull Codes.

* Specify 2-digit Code to select Cabinet Width. See this Section, page 4 for Cabinet Width Codes.

† Specify 4-digit Code to select Laminate/Color. See this Section, pages 5 & 6 for Laminate/Color Codes.



SSCI laminated products are available in SSCI standard laminates, SSCI optional laminates, or Customer selected laminates.

For Product Information Call TOLL-FREE 1-800-323-7366 • (847) 537-9320 • Fax (847) 537-9061

Hours: 8:30am - 5:00pm CST Monday - Friday

Visit our website at: www.suburbansurgical.com

Imperial 2 Cupboard Full Height Cabinets 40.75-in. (103.50cm)H Fixed Shelf



2 Open Cupboards

1 Fixed Shelf at 40.75-in. (103.50cm) H

4 Adjustable Shelves

Width: 12-in. to 36-in. (30.48cm to 91.44cm) in 3-in. (7.62cm) increments

Height: 84-in. (213.36cm)

Upper Cupboard: 42.625-in. (108.27cm) H

Lower Cupboard: 35.50-in. (90.17cm) H

P/N	DEPTH	
	In.	Cm
BWIPAAAA * MXCR - _ _ _ _ †	17.375	44.13
BWIPAAAA * MXDP - _ _ _ _ †	23.375	59.37

2 Open Cupboards, Corner

1 Fixed Shelf at 40.75-in. (103.50cm) H

4 Adjustable Shelves

Width: 12-in. (30.48cm)

Height: 84-in. (213.36cm)

Upper Cupboard: 42.625-in. (108.27cm) H

Lower Cupboard: 35.50-in. (90.17cm) H

P/N	DEPTH	
	In.	Cm
BZIPAAAA BVMXCR - _ _ _ _ †	17.375	44.13
BZIPAAAA BVMXDP - _ _ _ _ †	23.375	59.37



Open Cupboard over 1 Door Hinged left or right

1 Fixed Shelf at 40.75-in. (103.50cm) H

4 Adjustable Shelves

Width: 12-in. to 24-in. (30.48cm to 60.96cm) in 3-in. (7.62cm) increments

Height: 84-in. (213.36cm)

Upper Cupboard: 42.625-in. (108.27cm) H

Lower Cupboard: 35.50-in. (90.17cm) H; 1 Door Hinged left or right

P/N	DEPTH	
	In.	Cm
BWIQAEEA ◊ ** MXCT - _ _ _ _ †	18	45.72
BWIRAEAA ◊ ** MXCT - _ _ _ _ †	24	60.96



Open Cupboard over Pair of Hinged Doors

1 Fixed Shelf at 40.75-in. (103.50cm) H

4 Adjustable Shelves

Width: 21-in. to 36-in. (53.34cm to 91.44cm) in 3-in. (7.62cm) increments

Height: 84-in. (213.36cm)

Upper Cupboard: 42.625-in. (108.27cm) H

Lower Cupboard: 35.50-in. (90.17cm) H; Pair of Hinged Doors

P/N	DEPTH	
	In.	Cm
BWISAEAA ◊ ** MXCT - _ _ _ _ †	18	45.72
BWISAEAA ◊ ** MXDR - _ _ _ _ †	24	60.96



Important: These customer order requirements, in addition to other customer order requirements, must be satisfied prior to the beginning of manufacturing lead time:

◊ Specify 1-digit Code to select type of drawer/door pull(s). See this Section, page 4 for drawer/door Pull Codes.

* Specify 2-digit Code to select Cabinet Width. See this Section, page 4 for Cabinet Width Codes.

† Specify 4-digit Code to select Laminate/Color. See this Section, pages 5 & 6 for Laminate/Color Codes.



SSCI laminated products are available in SSCI standard laminates, SSCI optional laminates, or Customer selected laminates.

Imperial 2 Cupboard Full Height Cabinets 40.75-in. (103.50cm)H Fixed Shelf

Open Cupboard over 1 Door Hinged left or right, Corner

1 Fixed Shelf at 40.75-in. (103.50cm) H

4 Adjustable Shelves

Width: 12-in. (30.48cm)

Height: 84-in. (213.36cm)

Upper Cupboard: 42.625-in. (108.27cm) H

Lower Cupboard: 35.50-in. (90.17cm) H; 1 Door Hinged left or right



P/N Hinged Left	Hinged Right	DEPTH	
		In.	Cm
BZIQAEAA ◊ BVMXCT - ___ †	BZIRAEAA ◊ BVMXCT - ___ †	18	45.72
BZIQAEAA ◊ BVMXDR - ___ †	BZIRAEAA ◊ BVMXDR - ___ †	24	60.96



1 Door over 1 Door, Hinged left or right

1 Fixed Shelf at 40.75-in. (103.50cm) H

4 Adjustable Shelves

Width: 12-in. to 24-in. (30.48cm to 60.96cm) in 3-in. (7.62cm) increments

Height: 84-in. (213.36cm)

Upper Cupboard: 42.625-in. (108.27cm) H; 1 Door Hinged left or right

Lower Cupboard: 35.50-in. (90.17cm) H; 1 Door Hinged left or right

P/N Hinged Left	Hinged Right	DEPTH	
		In.	Cm
BWITAEAA ◊ ** MXCT - ___ †	BWIUAEAA ◊ ** MXCT - ___ †	18	45.72
BWITAEAA ◊ ** MXDR - ___ †	BWIUAEAA ◊ ** MXDR - ___ †	24	60.96

Pair of Hinged Doors over Pair of Hinged Doors

1 Fixed Shelf at 40.75-in. (103.50cm) H

4 Adjustable Shelves

Width: 21-in. to 36-in. (53.34cm to 91.44cm) in 3-in. (7.62cm) increments

Height: 84-in. (213.36cm)

Upper Cupboard: 42.625-in. (108.27cm) H; Pair of Hinged Doors

Lower Cupboard: 35.50-in. (90.17cm) H; Pair of Hinged Doors



P/N	DEPTH	
	In.	Cm
BWIVAEAA ◊ ** MXCT - ___ †	18	45.72
BWIVAEAA ◊ ** MXDR - ___ †	24	60.96



1 Door over 1 Door, Hinged left or right, Corner

1 Fixed Shelf at 40.75-in.H (103.50cm) H

4 Adjustable Shelves

Width: 12-in. (30.48cm)

Height: 84-in. (213.36cm)

Upper Cupboard: 42.625-in. (108.27cm) H; 1 Door Hinged left or right

Lower Cupboard: 35.50-in. (90.17cm) H; 1 Door Hinged left or right

P/N Hinged Left	Hinged Right	DEPTH	
		In.	Cm
BZITAEAA ◊ BVMXCT - ___ †	BZIUAEAA ◊ BVMXCT - ___ †	18	45.72
BZITAEAA ◊ BVMXDR - ___ †	BZIUAEAA ◊ BVMXDR - ___ †	24	60.96

Important: These customer order requirements, in addition to other customer order requirements, must be satisfied prior to the beginning of manufacturing lead time:

◊ Specify 1-digit Code to select type of drawer/door pull(s). See this Section, page 4 for drawer/door Pull Codes.

* Specify 2-digit Code to select Cabinet Width. See this Section, page 4 for Cabinet Width Codes.

† Specify 4-digit Code to select Laminate/Color. See this Section, pages 5 & 6 for Laminate/Color Codes.



SSCI laminated products are available in SSCI standard laminates, SSCI optional laminates, or Customer selected laminates.

For Product Information Call TOLL-FREE 1-800-323-7366 • (847) 537-9320 • Fax (847) 537-9061

Hours: 8:30am - 5:00pm CST Monday - Friday

Visit our website at: www.suburbansurgical.com

Imperial 2 Cupboard Full Height Cabinets 67.25-in. (170.82cm)H Fixed Shelf



2 Open Cupboards

1 Fixed Shelf at 67.25-in. (170.82cm) H

4 Adjustable Shelves

Width: 12-in. to 36-in. (30.48cm to 91.44cm) in 3-in. (7.62cm) increments

Height: 84-in. (213.36cm)

Upper Cupboard: 16.75-in. (42.55cm) H

Lower Cupboard: 61.375-in. (155.89cm) H

P/N	DEPTH	
	In.	Cm
BWJAAAAA * _ MXCR - _ _ _ †	17.375	44.13
BWJAAAAA * _ MXDP - _ _ _ †	23.375	59.37

2 Open Cupboards, Corner

1 Fixed Shelf at 67.25-in. (170.82cm) H

4 Adjustable Shelves

Width: 12-in. (30.48cm)

Height: 84-in. (213.36cm)

Upper Cupboard: 16.75-in. (42.55cm) H

Lower Cupboard: 61.375-in. (155.89cm) H

P/N	DEPTH	
	In.	Cm
BZJAAAAABVMXCR - _ _ _ †	17.375	44.13
BZJAAAAABVMXDP - _ _ _ †	23.375	59.37



Open Cupboard over 1 Door Hinged left or right

1 Fixed Shelf at 67.25-in. (170.82cm) H

4 Adjustable Shelves

Width: 12-in. to 24-in. (30.48cm to 60.96cm) in 3-in. (7.62cm) increments

Height: 84-in. (213.36cm)

Upper Cupboard: 16.75-in. (42.55cm) H

Lower Cupboard: 61.375-in. (155.89cm) H; 1 Door Hinged left or right

P/N	Hinged Left	Hinged Right	DEPTH	
			In.	Cm
BWJBAEAA ◊ ** MXCT - _ _ _ †	BWJCAEAA ◊ ** MXCT - _ _ _ †	18	45.72	
BWJBAEAA ◊ ** MXDR - _ _ _ †	BWJCAEAA ◊ ** MXDR - _ _ _ †	24	60.96	



Open Cupboard over Pair of Hinged Doors

1 Fixed Shelf at 67.25-in. (170.82cm) H

4 Adjustable Shelves

Width: 21-in. to 36-in. (53.34cm to 91.44cm) in 3-in. (7.62cm) increments

Height: 84-in. (213.36cm)

Upper Cupboard: 16.75-in. (42.55cm) H

Lower Cupboard: 61.375-in. (155.89cm) H; Pair of hinged Doors

P/N	DEPTH	
	In.	Cm
BWJDAEAA ◊ ** MXCT - _ _ _ †	18	45.72
BWJDAEAA ◊ ** MXDR - _ _ _ †	24	60.96



Important: These customer order requirements, in addition to other customer order requirements, must be satisfied prior to the beginning of manufacturing lead time:

◊ Specify 1-digit Code to select type of drawer/door pull(s). See this Section, page 4 for drawer/door Pull Codes.

* Specify 2-digit Code to select Cabinet Width. See this Section, page 4 for Cabinet Width Codes.

† Specify 4-digit Code to select Laminate/Color. See this Section, pages 5 & 6 for Laminate/Color Codes.



SSCI laminated products are available in SSCI standard laminates, SSCI optional laminates, or Customer selected laminates.

Imperial 2 Cupboard Full Height Cabinets 67.25-in. (170.82cm)H Fixed Shelf

Open Cupboard over 1 Door Hinged left or right, Corner

1 Fixed Shelf at 67.25-in. (170.82cm) H

4 Adjustable Shelves

Width: 12-in. (30.48cm)

Height: 84-in. (213.36cm)

Upper Cupboard: 16.75-in. (42.55cm) H

Lower Cupboard: 61.375-in. (155.89cm) H; 1 Door Hinged left or right

P/N Hinged Left	Hinged Right	DEPTH	
		In.	Cm
BZJBAEAA ◊ BVMXCT - ___ †	BZJCAEAA ◊ BVMXCT - ___ †	18	45.72
BZJBAEAA ◊ BVMXDR - ___ †	BZJCAEAA ◊ BVMXDR - ___ †	24	60.96



1 Door over 1 Door, Hinged left or right

1 Fixed Shelf at 67.25-in. (170.82cm) H

4 Adjustable Shelves

Width: 12-in. to 24-in. (30.48cm to 60.96cm) in 3-in. (7.62cm) increments

Height: 84-in. (213.36cm)

Upper Cupboard: 16.75-in. (42.55cm) H; Door hinged left or right

Lower Cupboard: 61.375-in. (155.89cm) H; Door hinged left or right

P/N Hinged Left	Hinged Right	DEPTH	
		In.	Cm
BWJMAEAA ◊ ** MXCT - ___ †	BWJNAEAA ◊ ** MXCT - ___ †	18	45.72
BWJMAEAA ◊ ** MXDR - ___ †	BWJNAEAA ◊ ** MXDR - ___ †	24	60.96

Pair of Hinged Doors over Pair of Hinged Doors

1 Fixed Shelf at 67.25-in. (170.82cm) H

4 Adjustable Shelves

Width: 21-in. to 36-in. (53.34cm to 91.44cm) in 3-in. (7.62cm) increments

Height: 84-in. (213.36cm)

Upper Cupboard: 16.75-in. (42.55cm) H; Pair of Hinged Doors

Lower Cupboard: 61.375-in. (155.89cm) H; Pair of Hinged Doors

P/N	DEPTH	
	In.	Cm
BWJJOAEAA ◊ ** MXCT - ___ †	18	45.72
BWJJOAEAA ◊ ** MXDR - ___ †	24	60.96



1 Door over 1 Door, Hinged left or right, Corner

1 Fixed Shelf at 67.25-in. (170.82cm) H

4 Adjustable Shelves

Width: 12-in. (30.48cm)

Height: 84-in. (213.36cm)

Upper Cupboard: 16.75-in. (42.55cm) H; Door hinged left or right

Lower Cupboard: 61.375-in. (155.89cm) H; Door hinged left or right

P/N Hinged Left	Hinged Right	DEPTH	
		In.	Cm
BZJMAEAA ◊ BVMXCT - ___ †	BZJNAEAA ◊ BVMXCT - ___ †	18	45.72
BZJMAEAA ◊ BVMXDR - ___ †	BZJNAEAA ◊ BVMXDR - ___ †	24	60.96

Important: These customer order requirements, in addition to other customer order requirements, must be satisfied prior to the beginning of manufacturing lead time:

◊ Specify 1-digit Code to select type of drawer/door pull(s). See this Section, page 4 for drawer/door Pull Codes.

* Specify 2-digit Code to select Cabinet Width. See this Section, page 4 for Cabinet Width Codes.

† Specify 4-digit Code to select Laminate/Color. See this Section, pages 5 & 6 for Laminate/Color Codes.



SSCI laminated products are available in SSCI standard laminates, SSCI optional laminates, or Customer selected laminates.

For Product Information Call TOLL-FREE 1-800-323-7366 • (847) 537-9320 • Fax (847) 537-9061

Hours: 8:30am - 5:00pm CST Monday - Friday

Visit our website at: www.suburbansurgical.com

Finishing Components For Imperial Full Height Cabinets

Installation against 1 wall

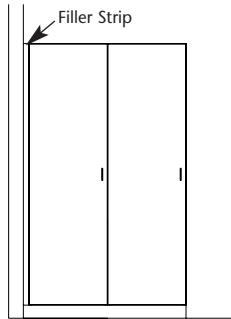

Installation between 2 walls

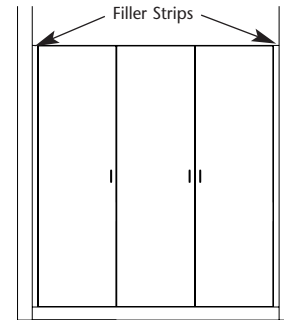

Filler Strips for Full Height Cabinets

P/N	WIDE		HEIGHT		DEPTH	
	In.	Cm	In.	Cm	In.	Cm
Full Height						
DWODAEAAAAGMXAC-___-†	1.75	4.45	84	213.36	.625	1.59
DWODAEAAAANMXAC-___-†	3.50	8.89	84	213.36	.625	1.59

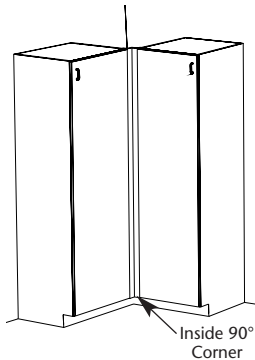

Inside 90° Corner for Full Height Cabinets

P/N	WIDE		HEIGHT		DEPTH	
	In.	Cm	In.	Cm	In.	Cm
DWOAAEAAAAIMXAI-___-†	2.25	5.715	84	213.36	2.25	5.715

Toe Kick Lengths for Full Height Cabinets

P/N	WIDE		HEIGHT		DEPTH	
	In.	Cm	In.	Cm	In.	Cm
DROJAEAAAOTAPAC-___-†	96	243.84	4	10.16	.625	1.59

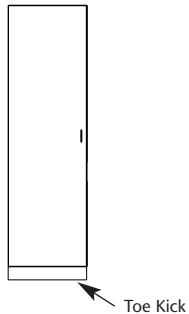

Back Panels for Full Height Cabinets

Back Panel Custom Widths; Full Height 84-in. (213.36cm) H

P/N	WIDTH		HEIGHT		THICKNESS	
	In.	Cm	In.	Cm	In.	Cm
DWONAEAAA * * MXAA-___-†	As Required		84	213.36	.625	1.59

Important: These customer order requirements, in addition to other customer order requirements, must be satisfied prior to the beginning of manufacturing lead time:

*Specify 2-digit Code to select Cabinet Width. See this Section, page 4 for Cabinet Width Codes.

†Specify 4-digit Code to select Laminate/Color. See this Section, pages 5 & 6 for Laminate/Color Codes.



SSCI laminated products are available in SSCI standard laminates, SSCI optional laminates, or Customer selected laminates.

End Panels for Full Height Cabinets

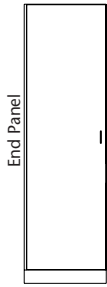

End Panel; Floor to Full Height

P/N	THICKNESS		HEIGHT		DEPTH	
	In.	Cm	In.	Cm	In.	Cm
DWOKAEAAAACMXCR-___†	.625	1.59	84	213.36	17.375	44.13
DWOKAEAAAACMXCT-___†	.625	1.59	84	213.36	18	45.72
DWOKAEAAAACMXDP-___†	.625	1.59	84	213.36	23.375	59.37
DWOKAEAAAACMXDR-___†	.625	1.59	84	213.36	24	60.96

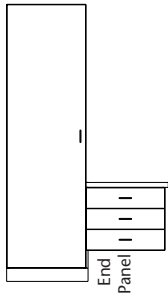

End Panel; Floor to Wall-Mount mounted at Reception Height

P/N	THICKNESS		HEIGHT		DEPTH	
	In.	Cm	In.	Cm	In.	Cm
DROLAEAAAACBLCR-___†	.625	1.59	9.375	23.81	17.375	44.13
DROLAEAAAACBLCT-___†	.625	1.59	9.375	23.81	18	45.72
DROLAEAAAACBLDP-___†	.625	1.59	9.375	23.81	23.375	59.37
DROLAEAAAACBLDR-___†	.625	1.59	9.375	23.81	24	60.96

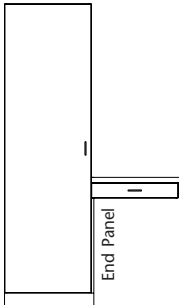

End Panel; Floor to Desk mounted at Reception Height

P/N	THICKNESS		HEIGHT		DEPTH	
	In.	Cm	In.	Cm	In.	Cm
DROLAEAAAACDOCR-___†	.625	1.59	23.25	59.06	17.375	44.13
DROLAEAAAACDOCT-___†	.625	1.59	23.25	59.06	18	45.72
DROLAEAAAACDODP-___†	.625	1.59	23.25	59.06	23.375	59.37
DROLAEAAAACDODR-___†	.625	1.59	23.25	59.06	24	60.96

Important: These customer order requirements, in addition to other customer order requirements, must be satisfied prior to the beginning of manufacturing lead time:

*Specify 2-digit Code to select Cabinet Width. See this Section, page 4 for Cabinet Width Codes.

†Specify 4-digit Code to select Laminate/Color. See this Section, pages 5 & 6 for Laminate/Color Codes.



SSCI laminated products are available in SSCI standard laminates, SSCI optional laminates, or Customer selected laminates.

For Product Information Call TOLL-FREE 1-800-323-7366 • (847) 537-9320 • Fax (847) 537-9061

Hours: 8:30am - 5:00pm CST Monday - Friday

Visit our website at: www.suburbansurgical.com

Finishing Components for Imperial Full Height Cabinets

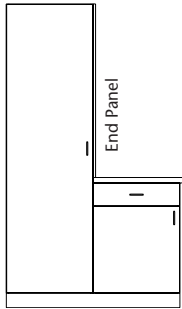

End Panel; Above Reception Height to Full Height

P/N	THICKNESS		HEIGHT		DEPTH	
	In.	Cm	In.	Cm	In.	Cm
DWOLAEAAAACIHDR-___†	.625	1.59	54	137.16	17.375	44.13
DWOLAEAAAACIHCT-___†	.625	1.59	54	137.16	18	45.72
DWOLAEAAAACIHDP-___†	.625	1.59	54	137.16	23.375	59.37
DWOLAEAAAACIHDR-___†	.625	1.59	54	137.16	24	60.96

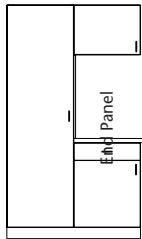

End Panel; Above Reception Height to 18-in. (45.72cm) Upper Abutted to a Full Height

P/N	THICKNESS		HEIGHT		DEPTH	
	In.	Cm	In.	Cm	In.	Cm
DWOLAEAAAACFNCR-___†	.625	1.59	36	91.44	17.375	44.13
DWOLAEAAAACFNCT-___†	.625	1.59	36	91.44	18	45.72
DWOLAEAAAACFNDR-___†	.625	1.59	36	91.44	23.375	59.37
DWOLAEAAAACFNDR-___†	.625	1.59	36	91.44	24	60.96

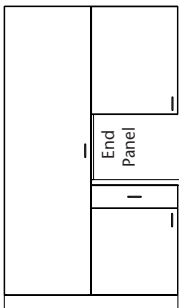

End Panel; Above Reception Height to 30-in. (76.20cm) Upper Abutted to a Full Height

P/N	THICKNESS		HEIGHT		DEPTH	
	In.	Cm	In.	Cm	In.	Cm
DWOLAEAAAACDRCR-___†	.625	1.59	24	60.96	17.375	44.13
DWOLAEAAAACDRCT-___†	.625	1.59	24	60.96	18	45.72
DWOLAEAAAACDRDP-___†	.625	1.59	24	60.96	23.375	59.37
DWOLAEAAAACDRDR-___†	.625	1.59	24	60.96	24	60.96

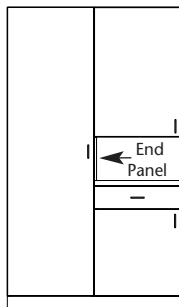

End Panel; Above Reception Height to 36-in. (91.44cm) Upper Abutted to a Full Height

P/N	THICKNESS		HEIGHT		DEPTH	
	In.	Cm	In.	Cm	In.	Cm
DWOLAEAAAACCTCR-___†	.625	1.59	18	45.72	17.375	44.13
DWOLAEAAAACCTCT-___†	.625	1.59	18	45.72	18	45.72
DWOLAEAAAACCTDP-___†	.625	1.59	18	45.72	23.375	59.37
DWOLAEAAAACCTDR-___†	.625	1.59	18	45.72	24	60.96

Important: These customer order requirements, in addition to other customer order requirements, must be satisfied prior to the beginning of manufacturing lead time:

*Specify 2-digit Code to select Cabinet Width. See this Section, page 4 for Cabinet Width Codes.

†Specify 4-digit Code to select Laminate/Color. See this Section, pages 5 & 6 for Laminate/Color Codes.



SSCI laminated products are available in SSCI standard laminates, SSCI optional laminates, or Customer selected laminates.

Finishing Components for Imperial Full Height Cabinets

End Panels for Full Height Cabinets

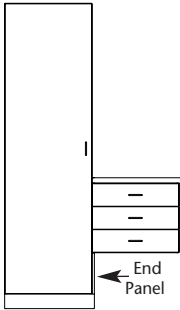

End Panel; Floor to Wall-Mount mounted at Standard Height

P/N	THICKNESS		HEIGHT		DEPTH	
	In.	Cm	In.	Cm	In.	Cm
DROLAEEAAAACCJCR-___†	.625	1.59	15.375	39.05	17.375	44.13
DROLAEEAAAACCJCT-___†	.625	1.59	15.375	39.05	18	45.72
DROLAEEAAAACCJDP-___†	.625	1.59	15.375	39.05	23.375	59.37
DROLAEEAAAACCJDR-___†	.625	1.59	15.375	39.05	24	60.96

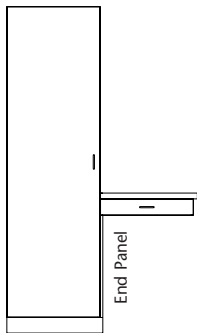

End Panel; Floor to Desk mounted at Standard Height

P/N	THICKNESS		HEIGHT		DEPTH	
	In.	Cm	In.	Cm	In.	Cm
DROLAEEAAAACEMCR-___†	.625	1.59	29.25	74.30	17.375	44.13
DROLAEEAAAACEMCT-___†	.625	1.59	29.25	74.30	18	45.72
DROLAEEAAAACEMDP-___†	.625	1.59	29.25	74.30	23.375	59.37
DROLAEEAAAACEMDR-___†	.625	1.59	29.25	74.30	24	60.96

Important: These customer order requirements, in addition to other customer order requirements, must be satisfied prior to the beginning of manufacturing lead time:

*Specify 2-digit Code to select Cabinet Width. See this Section, page 4 for Cabinet Width Codes.

†Specify 4-digit Code to select Laminate/Color. See this Section, pages 5 & 6 for Laminate/Color Codes.



SSCI laminated products are available in SSCI standard laminates, SSCI optional laminates, or Customer selected laminates.

For Product Information Call TOLL-FREE 1-800-323-7366 • (847) 537-9320 • Fax (847) 537-9061

Hours: 8:30am - 5:00pm CST Monday - Friday

Visit our website at: www.suburbansurgical.com

Finishing Components for Imperial Full Height Cabinets

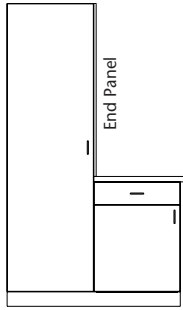

End Panel; Above Standard Height to Full Height

P/N	THICKNESS		HEIGHT		DEPTH	
	In.	Cm	In.	Cm	In.	Cm
DWOLAEAAAACHJCR-___†	.625	1.59	48	121.92	17.375	44.13
DWOLAEAAAACHJCT-___†	.625	1.59	48	121.92	18	45.72
DWOLAEAAAACHJDP-___†	.625	1.59	48	121.92	23.375	59.37
DWOLAEAAAACHJDR-___†	.625	1.59	48	121.92	24	60.96

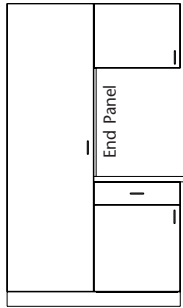

End Panel; Above Standard Height to 18-in. (45.72cm) Upper Abutted to a Full Height

P/N	THICKNESS		HEIGHT		DEPTH	
	In.	Cm	In.	Cm	In.	Cm
DWOLAEAAAACEPCR-___†	.625	1.59	30	76.20	17.375	44.13
DWOLAEAAAACEPCT-___†	.625	1.59	30	76.20	18	45.72
DWOLAEAAAACEPDP-___†	.625	1.59	30	76.20	23.375	59.37
DWOLAEAAAACEPDR-___†	.625	1.59	30	76.20	24	60.96

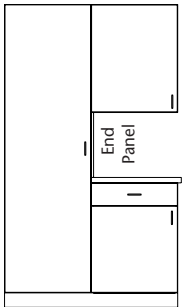

End Panel; Above Standard Height to 30-in. (76.20cm) Upper Abutted to a Full Height

P/N	THICKNESS		HEIGHT		DEPTH	
	In.	Cm	In.	Cm	In.	Cm
DWOLAEAAAACCTCR-___†	.625	1.59	18	45.72	17.375	44.13
DWOLAEAAAACCTCT-___†	.625	1.59	18	45.72	18	45.72
DWOLAEAAAACCTDP-___†	.625	1.59	18	45.72	23.375	59.37
DWOLAEAAAACCTDR-___†	.625	1.59	18	45.72	24	60.96

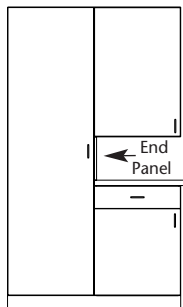

End Panel; Above Standard Height to 36-in. (91.44cm) Upper Abutted to a Full Height

P/N	THICKNESS		HEIGHT		DEPTH	
	In.	Cm	In.	Cm	In.	Cm
DWOLAEAAAACBVCR-___†	.625	1.59	12	30.48	17.375	44.13
DWOLAEAAAACBVCT-___†	.625	1.59	12	30.48	18	45.72
DWOLAEAAAACBVDP-___†	.625	1.59	12	30.48	23.375	59.37
DWOLAEAAAACBVDR-___†	.625	1.59	12	30.48	24	60.96

Important: These customer order requirements, in addition to other customer order requirements, must be satisfied prior to the beginning of manufacturing lead time:

*Specify 2-digit Code to select Cabinet Width. See this Section, page 4 for Cabinet Width Codes.

†Specify 4-digit Code to select Laminate/Color. See this Section, pages 5 & 6 for Laminate/Color Codes.



SSCI laminated products are available in SSCI standard laminates, SSCI optional laminates, or Customer selected laminates.

Finishing Components for Imperial Full Height Cabinets

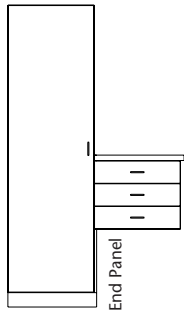

End Panel; Floor to Wall-Mount mounted at Exam Height

P/N	THICKNESS		HEIGHT		DEPTH	
	In.	Cm	In.	Cm	In.	Cm
DROLAEAAAACDICR-___†	.625	1.59	21.625	54.93	17.375	44.13
DROLAEAAAACDICT-___†	.625	1.59	21.625	54.93	18	45.72
DROLAEAAAACDIDP-___†	.625	1.59	21.625	54.93	23.375	59.37
DROLAEAAAACDIDR-___†	.625	1.59	21.625	54.93	24	60.96

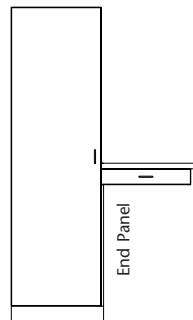

End Panel; Floor to Desk mounted at Exam Height

P/N	THICKNESS		HEIGHT		DEPTH	
	In.	Cm	In.	Cm	In.	Cm
DROLAEAAAACFLCR-___†	.625	1.59	35.50	90.17	17.375	44.13
DROLAEAAAACFLCT-___†	.625	1.59	35.50	90.17	18	45.72
DROLAEAAAACFLDP-___†	.625	1.59	35.50	90.17	23.375	59.37
DROLAEAAAACFLDR-___†	.625	1.59	35.50	90.17	24	60.96

Important: These customer order requirements, in addition to other customer order requirements, must be satisfied prior to the beginning of manufacturing lead time:

*Specify 2-digit Code to select Cabinet Width. See this Section, page 4 for Cabinet Width Codes.

†Specify 4-digit Code to select Laminate/Color. See this Section, pages 5 & 6 for Laminate/Color Codes.



SSCI laminated products are available in SSCI standard laminates, SSCI optional laminates, or Customer selected laminates.

For Product Information Call TOLL-FREE 1-800-323-7366 • (847) 537-9320 • Fax (847) 537-9061

Hours: 8:30am - 5:00pm CST Monday - Friday

Visit our website at: www.suburbansurgical.com

Finishing Components for Imperial Full Height Cabinets

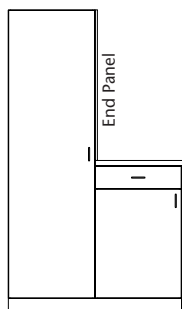

End Panel; Above Exam Height to Full Height

P/N	THICKNESS		HEIGHT		DEPTH	
	In.	Cm	In.	Cm	In.	Cm
DWOLAEAAAACGKCR-___†	.625	1.59	41.75	106.04	17.375	44.13
DWOLAEAAAACGKCT-___†	.625	1.59	41.75	106.04	18	45.72
DWOLAEAAAACGKDP-___†	.625	1.59	41.75	106.04	23.375	59.37
DWOLAEAAAACGKDR-___†	.625	1.59	41.75	106.04	24	60.96

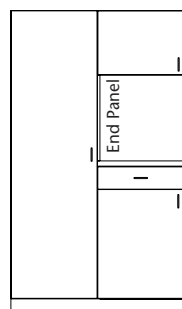

End Panel; Above Exam Height to 18-in. (45.72cm) Upper Abutted to a Full Height

P/N	THICKNESS		HEIGHT		DEPTH	
	In.	Cm	In.	Cm	In.	Cm
DWOLAEAAAACDQCR-___†	.625	1.59	23.75	60.33	17.375	44.13
DWOLAEAAAACDQCT-___†	.625	1.59	23.75	60.33	18	45.72
DWOLAEAAAACDQDP-___†	.625	1.59	23.75	60.33	23.375	59.37
DWOLAEAAAACDQDR-___†	.625	1.59	23.75	60.33	24	60.96

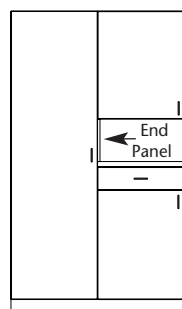

End Panel; Above Exam Height to 30-in. (76.20cm) Upper Abutted to a Full Height

P/N	THICKNESS		HEIGHT		DEPTH	
	In.	Cm	In.	Cm	In.	Cm
DWOLAEAAAACBUCR-___†	.625	1.59	11.75	29.84	17.375	44.13
DWOLAEAAAACBUCT-___†	.625	1.59	11.75	29.84	18	45.72
DWOLAEAAAACBUDP-___†	.625	1.59	11.75	29.84	23.375	59.37
DWOLAEAAAACBUDR-___†	.625	1.59	11.75	29.84	24	60.96

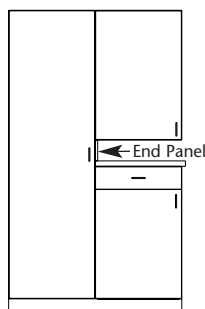

End Panel; Above Exam Height to 36-in. (91.44cm) Upper Abutted to a Full Height

P/N	THICKNESS		HEIGHT		DEPTH	
	In.	Cm	In.	Cm	In.	Cm
DWOLAEAAAACAWCR-___†	.625	1.59	5.75	14.60	17.375	44.13
DWOLAEAAAACAWCT-___†	.625	1.59	5.75	14.60	18	45.72
DWOLAEAAAACAWDP-___†	.625	1.59	5.75	14.60	23.375	59.37
DWOLAEAAAACAWDR-___†	.625	1.59	5.75	14.60	24	60.96

Important: These customer order requirements, in addition to other customer order requirements, must be satisfied prior to the beginning of manufacturing lead time:

*Specify 2-digit Code to select Cabinet Width. See this Section, page 4 for Cabinet Width Codes.

†Specify 4-digit Code to select Laminate/Color. See this Section, pages 5 & 6 for Laminate/Color Codes.



SSCI laminated products are available in SSCI standard laminates, SSCI optional laminates, or Customer selected laminates.

Accessorize Your Cabinets with Pull-Out Trays:

To eliminate constant bending over to view the contents of Undercounter and Full Height Cabinets, replace the cupboard's existing adjustable shelf with Pull-out Trays. Our uniquely-designed rollers/slides ensure that the Pull-out moves quietly, smoothly and with little effort. Typically, two trays are installed in each cupboard; one at the bottom and one midway. Pull-out trays for laminated products are white to match the interior of the cupboard.



P/N	CABINET DEPTH		CABINET WIDTH	
	18-in. (45.72cm)	24-in. (60.96cm)	In.	Cm
DRPAAEAAAABVAOCT	DRPAAEAAAABVAODR		12	30.48
DRPAAEAAAACHAOCT	DRPAAEAAAACHAODR		15	38.10
DRPAAEAAAACHTAOCT	DRPAAEAAAACHTAODR		18	45.72
DRPAAEAAAADFAOCT	DRPAAEAAAADFAODR		21	53.34
DRPAAEAAAADRAOCT	DRPAAEAAAADRAODR		24	60.96
DRPAAEAAAEDAOC	DRPAAEAAAEDAODR		27	68.58
DRPAAEAAAEPAOCT	DRPAAEAAAEPAODR		30	76.20
DRPAAEAAAFFBAOCT	DRPAAEAAAFFBAODR		33	83.82
DRPAAEAAAFFNAOCT	DRPAAEAAAFFNAODR		36	91.44
DRPAAEAAAFFZAOCT	DRPAAEAAAFFZAODR		39	99.06
DRPAAEAAAAGLAOCT	DRPAAEAAAAGLAODR		42	106.68

Complete your facility design with your choice of coordinated Countertops. Our Countertops are available in any color of high-pressure laminate. You can use the same Countertop surface throughout your facility, or select different surfaces for

different areas to ensure you have the best surface for the task at hand.

Some of our Countertop styles are shown here. Please call your SSCI or local authorized representative for help ordering the ideal Countertops for the Cabinetry in your facility.

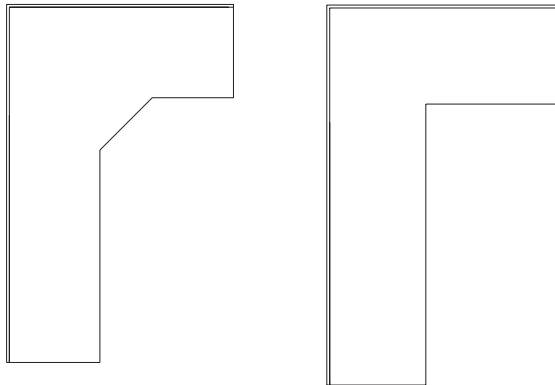

L-Shape Countertops

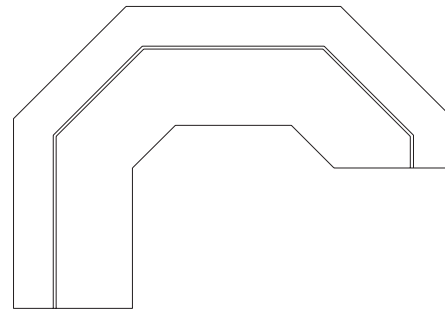

Reception Countertop with Check Ledge



Straight Countertop

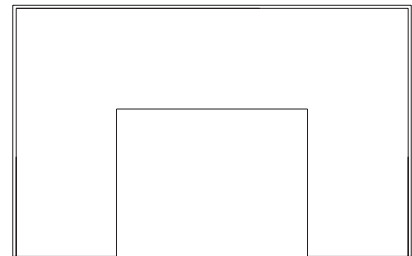

U-Shape Countertop